

THE TOWN OF ARLINGTON

SEWER DEPARTMENT

Side Street Plat
(PREPARE IN DUPLICATE)

Permit No. 582

Owner's Name Lewis O. Wheeler

Owner's Mailing Address 508 E. Gillman

Legal Description of Premises Lot 9-10-11 Block 11 Haller City Add.

Address of Property _____

Side Sewer Contractor _____

Mailing Address _____

Gillman

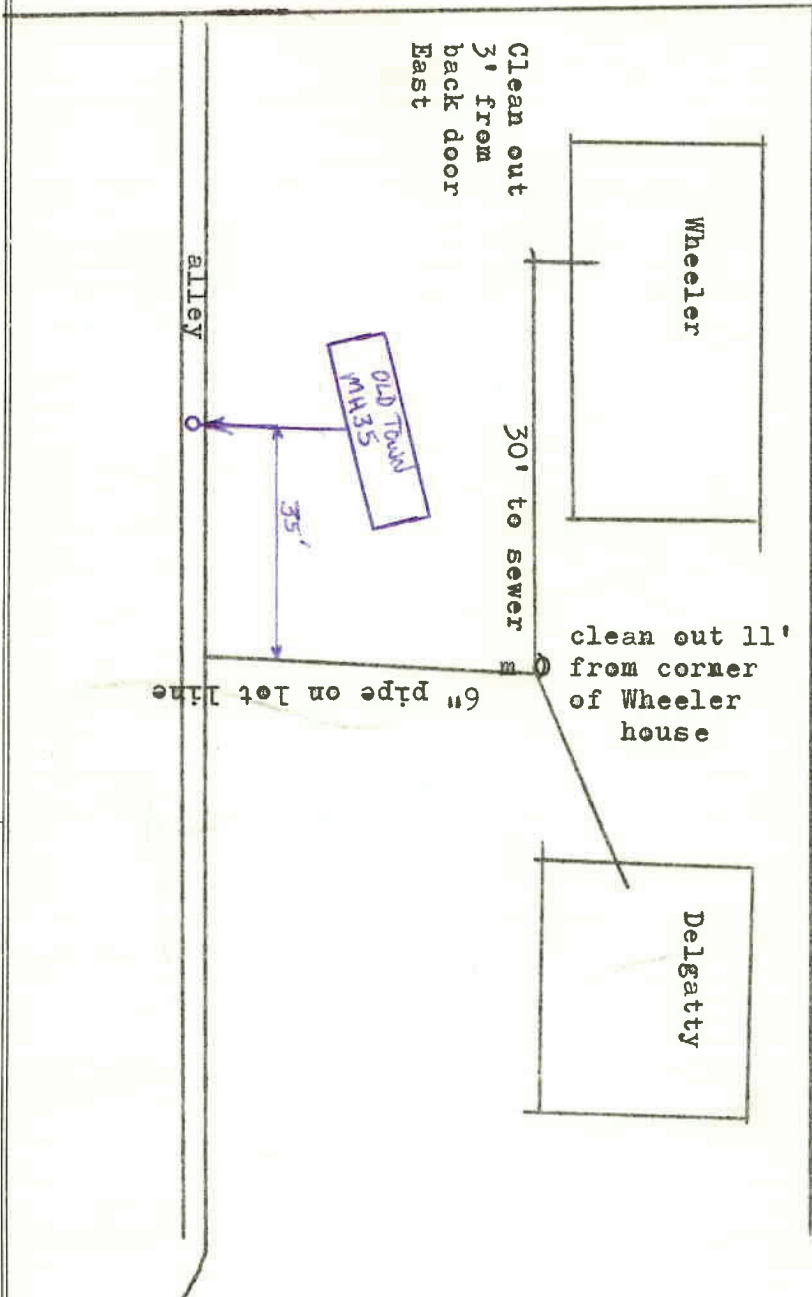

FILE COPY

01-6700.0

- 1. Commercial Single Residence Multiple Dwelling Joint Use
- 2. Distance from property line to sewer line 5'
- 3. Distance from house building line to property line 40'
- 4. Min. grade from main to property line 2% From property line to bldg. 2%
- 5. Distance from M. H. No. 21'
- 6. Depth: Sewer main 24"
- 7. Basement 21' Basement connection 21' (Reference to first floor)
- 8. Depth of pipe at house connection 21'
- 9. Type of pipe: Concrete Vitrified Clay Asbestos-Cement Size 4"
- 10. Remarks: _____

COMMERCIAL ONLY

- 1. Name _____
- 2. Type _____
- 3. Sq. Ft. Floor Space _____
- 4. No. of Floors _____
- 5. Remarks: _____

SPECIAL AGREEMENTS

- 1. Grade Release _____
- 2. High Grade Release _____
- 3. Non-Protecting Agmt. _____
- 4. Easement _____
- 5. Permission to Connect _____
- 6. Special _____

I hereby certify that the above connection has been made as shown:

Inspector _____ Date 6/16/67
 Date Permit Issued _____ Permit No. 582