

# THE TOWN OF ARLINGTON

## SEWER DEPARTMENT

Side Street Plat  
(PREPARE IN DUPLICATE)

Permit No. 305

Owner's Name Bevel Trucking Side Sewer Contractor 4835 Pine Street South  
 Owner's Mailing Address 1133 Maple Road Mailing Address 4835 Pine Street South  
 Legal Description of Premises lots 19 and 20 Collier Hill Part of 114 full corner Min

*Wetler Drain Clean out  
 1 foot 6 inches from southeast  
 corner of house East 9 feet out*

0853000

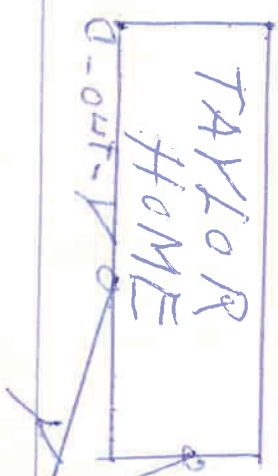

- 1. Commercial..... Single Residence  Multiple Dwelling..... Joint Use.....
- 2. Distance from property line to sewer line.....
- 3. Distance from house building line to property line..... From property line to bldg. 11 1/2
- 4. Min. grade from main to property line.....
- 5. Distance from M. H. No. ....
- 6. Depth: Sewer main 1 Basement connection 1 1/2 (Reference to first floor)
- 7. Basement.....
- 8. Depth of pipe at house connection..... Vitrified Clay..... Asbestos-Cement..... Size 4"
- 9. Type of pipe: Concrete..... Vitrified Clay..... Asbestos-Cement.....
- 10. Remarks: .....

### COMMERCIAL ONLY

- 1. Name .....
- 2. Type .....
- 3. Sq. Ft. Floor Space .....
- 4. No. of Floors .....
- 5. Remarks: .....

### SPECIAL AGREEMENTS

- 1. Grade Release .....
- 2. High Grade Release .....
- 3. Non-Profiting Agmt. ....
- 4. Easement .....
- 5. Permission to Connect .....
- 6. Special .....

I hereby certify that the above connection has been made as shown:  
 Inspector Henry Spencer Date 11/1/05  
 Date Permit Issued..... Permit No. 305