

**THE TOWN OF ARLINGTON**  
SEWER DEPARTMENT

Side 8 of Plat  
(PREPARE IN DUPLICATE)

Permit No. 466

Owner's Name MARVIN F West

Owner's Mailing Address 420 Highland Drive Arlington

Legal Description of Premises West 80.5' of N 170' of NE 1/4 Sec 8 of Twp 31 N R 5 & W 11

Address of Property 420 Highland Drive

Side Sewer Contractor Ken Sather - self

Mailing Address Marysville, Wash.

**FILE COPY**

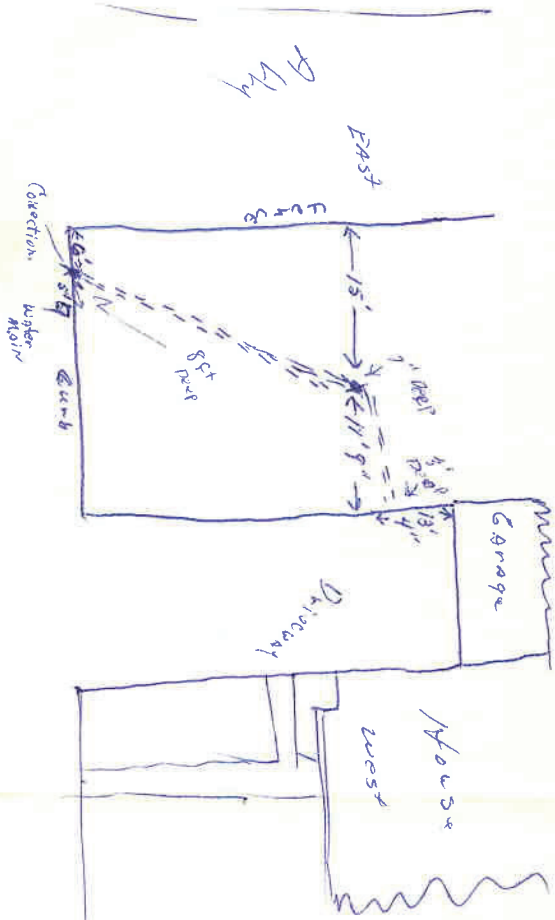

*Handwritten notes:*  
Highland Drive  
Freeway

- 1. Commercial  Single Residence  Multiple Dwelling  Joint Use
- 2. Distance from property line to sewer line
- 3. Distance from house building line to property line
- 4. Min. grade from main to property line          From property line to bldg
- 5. Distance from M. H. No.
- 6. Depth: Sewer main 8'
- 7. Basement          Basement connection          (Reference to first floor)
- 8. Depth of pipe at house connection         , Vitrified Clay         , Asbestos-Cement         , Size 4"
- 9. Type of pipe: Concrete         , Vitrified Clay         , Asbestos-Cement         , Size
- 10. Remarks:

**COMMERCIAL ONLY**

- 1. Name
- 2. Type
- 3. Sq. Ft. Floor Space
- 4. No. of Floors
- 5. Remarks:

**SPECIAL AGREEMENTS**

- 1. Grade Release
- 2. High Grade Release
- 3. Non-Protecting Agmt.
- 4. Easement
- 5. Permission to Connect
- 6. Special

I hereby certify that the above connection has been made as shown:

Inspector [Signature] Date 1/30/63  
Date Permit Issued          Permit No.         

6/20

08-4600.0