

THE TOWN OF ARLINGTON

SEWER DEPARTMENT

Side Section or Plat
(PREPARE IN DUPLICATE)

Permit No. 394

Owner's Name HAROLD LADD
 Owner's Mailing Address 1003 S DUNHAM
 Legal Description of Premises GARBS ADD TO ANE LOTS 9 AND 10

Address of Property 1003 S Dunham
 Side Sewer Contractor Charles J. ...
 Mailing Address 1414 ...

7 1/2 FEET WEST OF ADAMS HOUSE
15 FEET NORTH TO LAND HOUSE

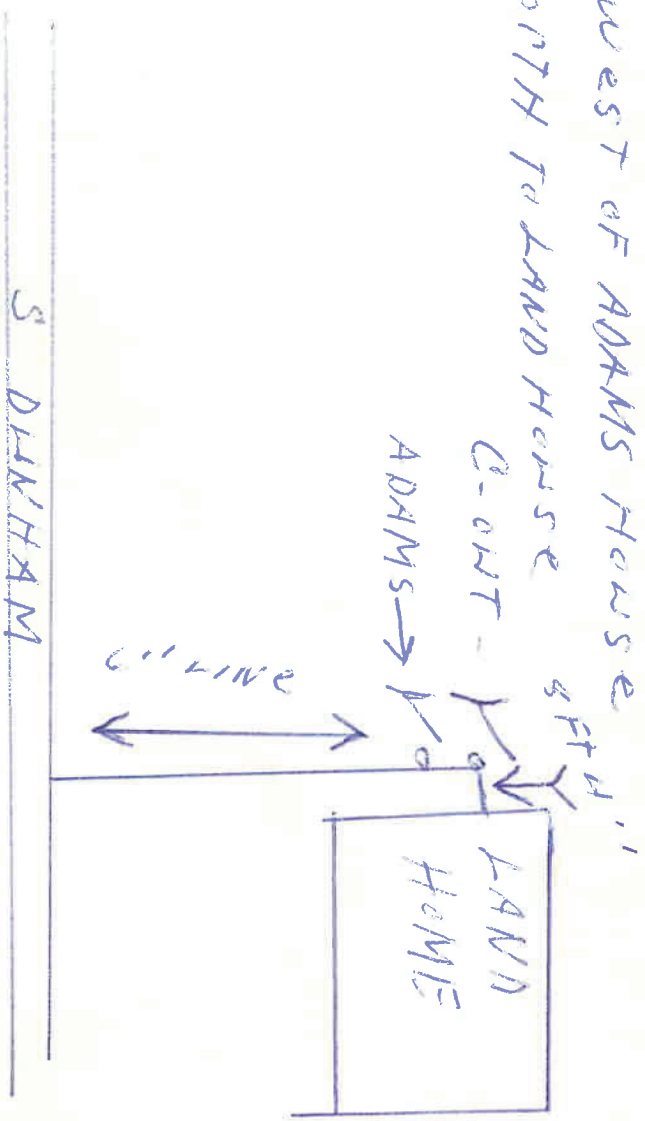

3 DUNHAM

10-23000

- 1. Commercial Single Residence Multiple Dwelling Joint Use
- 2. Distance from property line to sewer line
- 3. Distance from house building line to property line From property line to bldg. 2' 10"
- 4. Min. grade from main to property line
- 5. Distance from M. H. No.
- 6. Depth: Sewer main
- 7. Basement Basement connection No
- 8. Depth of pipe at house connection (Reference to first floor)
- 9. Type of pipe: Concrete Vitrified Clay Asbestos-Cement Size
- 10. Remarks: ONE SIX IN LINE

COMMERCIAL ONLY

SPECIAL AGREEMENTS

- 1. Name
- 2. Type
- 3. Sq. Ft. Floor Space
- 4. No. of Floors
- 5. Remarks:
- 1. Grade Release
- 2. High Grade Release
- 3. Non-Protecting Agmt.
- 4. Easement
- 5. Permission to Connect
- 6. Special

I hereby certify that the above connection has been made as shown:
 Inspector Henry ... Date 9/29/60
 Date Permit Issued 9/29/60 Permit No. 394