

THE TOWN OF ARLINGTON

SEWER DEPARTMENT

Side Sewer Plat
(PREPARE IN DUPLICATE)

Permit No. 548

Owner's Name E Robert Meier

Owner's Mailing Address 401 Clara St, Arlington, Wash,

Legal Description of Premises Lot 7 less NW 1/2, Also NW 1/4 of lot 8 - Wroblewski Add.

Address of Property 401 Clara St - Arlington, Wash

Side Sewer Contractor Owner

Waste Acct # 3972

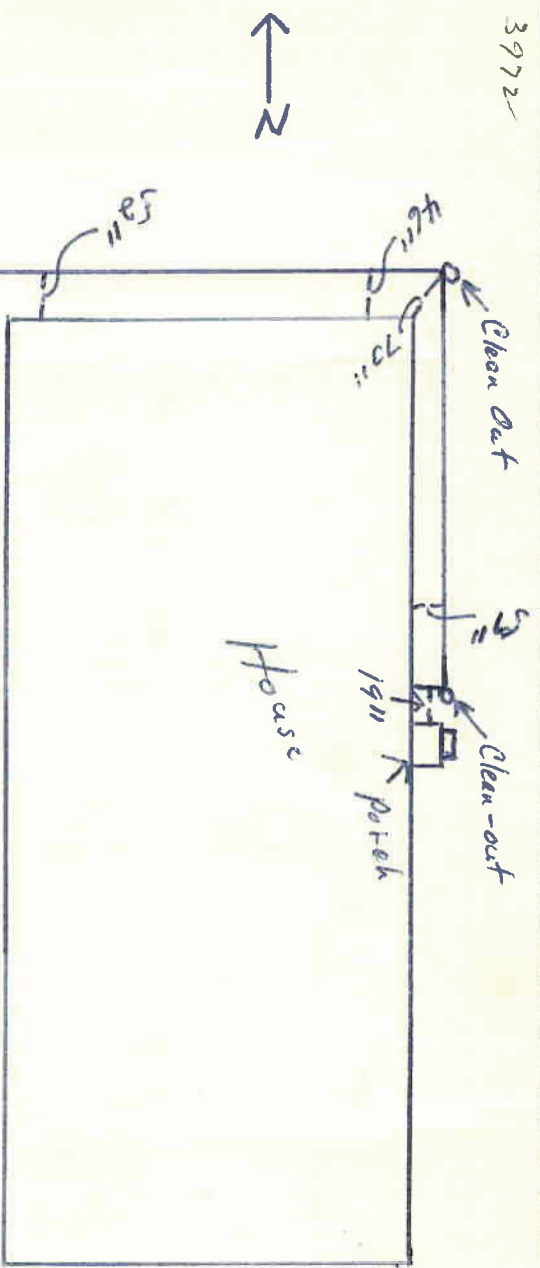

FILE COPY

05-93000

11/29/68 Issue Bob Meier, Permit No.

- 1. Commercial..... Single Residence..... Multiple Dwelling..... Joint Use.....
- 2. Distance from property line to sewer line.....
- 3. Distance from house building line to property line..... From property line to bldg. 10' 0"
- 4. Min. grade from main to property line.....
- 5. Distance from M. H. No.
- 6. Depth: Sewer main No
- 7. Basement..... No Basement connection No (Reference to first page)
- 8. Depth of pipe at house connection..... Vitrified Clay Asbestos-Cement..... Size 6"
- 9. Type of pipe: Concrete..... Vitrified Clay Asbestos-Cement..... Size.....
- 10. Remarks:

- COMMERCIAL ONLY**
- 1. Name
 - 2. Type
 - 3. Sq. Ft. Floor Space
 - 4. No. of Floors
 - 5. Remarks:

- SPECIAL AGREEMENTS**
- 1. Grade Release
 - 2. High Grade Release
 - 3. Non-Protecting Agmt.
 - 4. Easement
 - 5. Permission to Connect
 - 6. Special

I hereby certify that the above connection has been made as shown:
 Inspector [Signature] Date 3/21/68
 Date Permit Issued [Signature] Permit No. 548