

THE TOWN OF ARLINGTON

SEWER DEPARTMENT

Side S, r Plat
(PREPARE IN DUPLICATE)

Permit No. 61

4780

Owner's Name Thompson & Sons
 Owner's Mailing Address 320-3rd St.
 Legal Description of Premises Lot 172 B.2 Arlington Code.

Address of Property 320-3rd St. Arlington
 Side Sewer Contractor Thompson & Sons Co.
 Mailing Address 4608-36th St. SW. Seattle

M. J. Urban

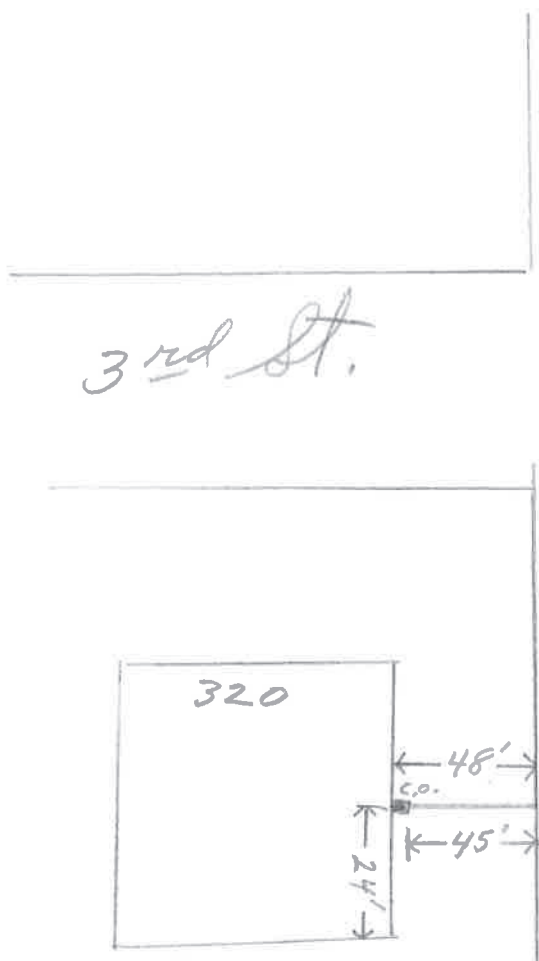

06-3500.0

- 1. Commercial Single Residence Multiple Dwelling Joint Use
- 2. Distance from property line to sewer line
- 3. Distance from house building line to property line From property line to bldg. 24'
- 4. Min. grade from main to property line
- 5. Distance from M. H. No.
- 6. Depth: Sewer main
- 7. Basement Basement connection (Reference to first floor)
- 8. Depth of pipe at house connection Vitrified Clay Asbestos-Cement Size
- 9. Type of pipe: Concrete Vitrified Clay Asbestos-Cement Size
- 10. Remarks:

- | | |
|---|--|
| <p>COMMERCIAL ONLY</p> <ul style="list-style-type: none"> 1. Name 2. Type 3. Sq. Ft. Floor Space 4. No. of Floors 5. Remarks: | <p>SPECIAL AGREEMENTS</p> <ul style="list-style-type: none"> 1. Grade Release 2. High Grade Release 3. Non-Protecting Agmt. 4. Easement 5. Permission to Connect 6. Special |
|---|--|
- I hereby certify that the above connection has been made as shown:
 Inspector Henry [Signature] Date 11/4/60
 Date Permit Issued _____ Permit No. 61