

**THE TOWN OF ARLINGTON**  
SEWER DEPARTMENT

4750

Side Sewer Plat  
(PREPARE IN DUPLICATE)

Permit No. 439

Owner's Name JK JOHNSON

Owner's Mailing Address 217 N. DUNHAM

Legal Description of Premises LOTS 13-14-15

Address of Property 217 N. DUNHAM

Side Sewer Contractor CHARLES P SMYTH

Mailing Address Box 227A RT 1 MILVERDALE

BLK 3 ARL.

4-Ft e-out  
Shared stub with 225 N. Dunham  
Permit # 440. YKR 09/10/2003

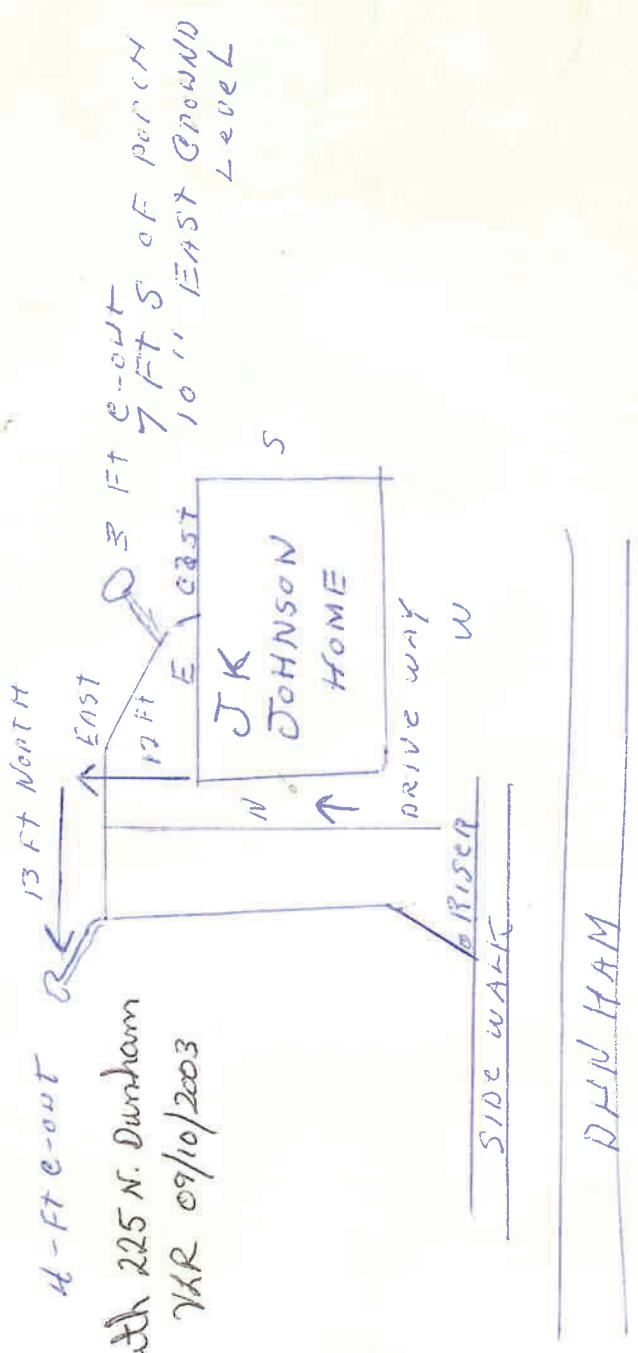

**FILE COPY**

De. 32000

COMMERCIAL ONLY	SPECIAL AGREEMENTS
1. Name	1. Grade Release
2. Type	2. High Grade Release
3. Sq. Ft. Floor Space	3. Non-Protecting Agmt.
4. No. of Floors	4. Easement
5. Remarks:	5. Permission to Connect
6. Special	6. Special

I hereby certify that the above connection has been made as shown:  
 Inspector Charles P Smyth Date 9/29/03  
 Date Permit Issued 9/29/03 Permit No. 439

1. Commercial..... Single Residence..... Multiple Dwelling..... Joint Use.....

2. Distance from property line to sewer line.....

3. Distance from house building line to property line..... From property line to bldg. N/A

4. Min. grade from main to property line.....

5. Distance from M. H. No. ....

6. Depth: Sewer main.....

7. Basement..... Basement connection Yes

8. Depth of pipe at house connection..... (Reference to first floor)

9. Type of pipe: Concrete 6" 15, Vitrified Clay ✓, Asbestos-Cement....., Size 6" 15

10. Remarks: Shared stub with Dunham