

# THE TOWN OF ARLINGTON

## SEWER DEPARTMENT

Side S, r Plat  
(PREPARE IN DUPLICATE)

Permit No. 276

Owner's Name Edward Lundquist  
 Owner's Mailing Address 124 W. Selman  
 Legal Description of Premises Lots 14+15-Block 7 - Hollen City Add

Address of Property 124 W. Selman  
 Side Sewer Contractor Shelburne and Fogarty Co.  
 Mailing Address 4608-36 1/2 S.W. Seattle

*W. Selman*

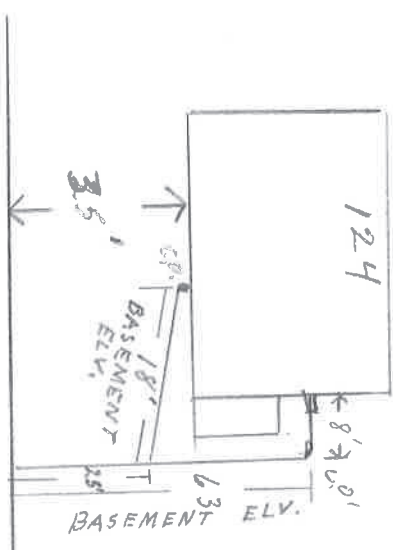

*Alley*

*02-85500D*

- 1. Commercial  Single Residence  Multiple Dwelling  Joint Use
- 2. Distance from property line to sewer line
- 3. Distance from house building line to property line  From property line to bldg. 3' 0"
- 4. Min. grade from main to property line
- 5. Distance from M. H. No.
- 6. Depth: Sewer main  Basement connection  (Reference to first floor)
- 7. Basement
- 8. Depth of pipe at house connection  Vitrified Clay  Asbestos-Cement  Size
- 9. Type of pipe: Concrete  Asbestos-Cement  Size
- 10. Remarks:

COMMERCIAL ONLY		SPECIAL AGREEMENTS	
1. Name		1. Grade Release	
2. Type		2. High Grade Release	
3. Sq. Ft. Floor Space		3. Non-Protecting Agmt.	
4. No. of Floors		4. Easement	
5. Remarks:		5. Permission to Connect	
		6. Special	

I hereby certify that the above connection has been made as shown:

Inspector Wm. J. ... Date 11/8/60

Date Permit Issued 11/8/60 Permit No. 276