

# THE TOWN OF ARLINGTON

## SEWER DEPARTMENT

Side Street Plat  
(PREPARE IN DUPLICATE)

Permit No. 199

Owner's Name C. R. Emmelharts  
 Owner's Mailing Address 112 Gilman Ave.  
 Legal Description of Premises Block 7 - Waller City Add

Address of Property 112 Gilman Ave.  
 Side Sewer Contractor Shelburne and Sons Co.  
 Mailing Address 4608 - 36th S.W. Seattle

*Gilman Ave*

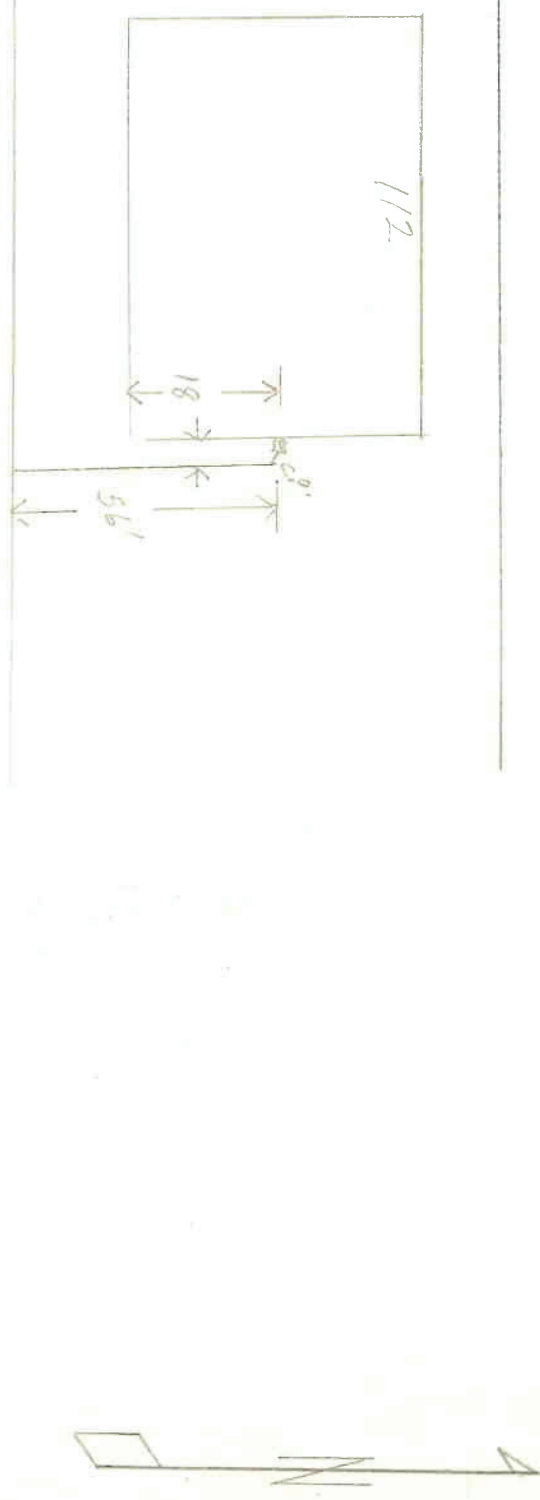

*Alley*

02-0900.0

- 1. Commercial..... Single Residence..... Multiple Dwelling..... Joint Use.....
- 2. Distance from property line to sewer line.....
- 3. Distance from house building line to property line..... From property line to h/dg. 18'
- 4. Min. grade from main to property line.....
- 5. Distance from M. H. No.....
- 6. Depth: Sewer main..... Basement connection.....
- 7. Basement..... (Reference to first floor).....
- 8. Depth of pipe at house connection....., Vitrified Clay....., Asbestos-Cement....., Size.....
- 9. Type of pipe: Concrete....., Vitrified Clay....., Asbestos-Cement....., Size.....
- 10. Remarks:.....

### COMMERCIAL ONLY

- 1. Name.....
- 2. Type.....
- 3. Sq. Ft. Floor Space.....
- 4. No. of Floors.....
- 5. Remarks:.....

### SPECIAL AGREEMENTS

- 1. Grade Release.....
- 2. High Grade Release.....
- 3. Non-Protessing Agmt.....
- 4. Easement.....
- 5. Permission to Connect.....
- 6. Special.....

I hereby certify that the above connection has been made as shown:  
 Inspector Jimmy Spinner Date 1/14/68  
 Date Permit Issued..... Permit No. 199