

# THE TOWN OF ARLINGTON

## SEWER DEPARTMENT

Side Sewer Plat  
(PREPARE IN DUPLICATE)

Permit No. 151

1090

Owner's Name Mrs. Pamela Walker  
 Owner's Mailing Address 13-16-30 Oak St

Address of Property 13-14-15-16  
 Side Sewer Contractor Robert J. Gaudin  
 Mailing Address 13-14-15-16

Legal Description of Premises 13-16-30 Oak St

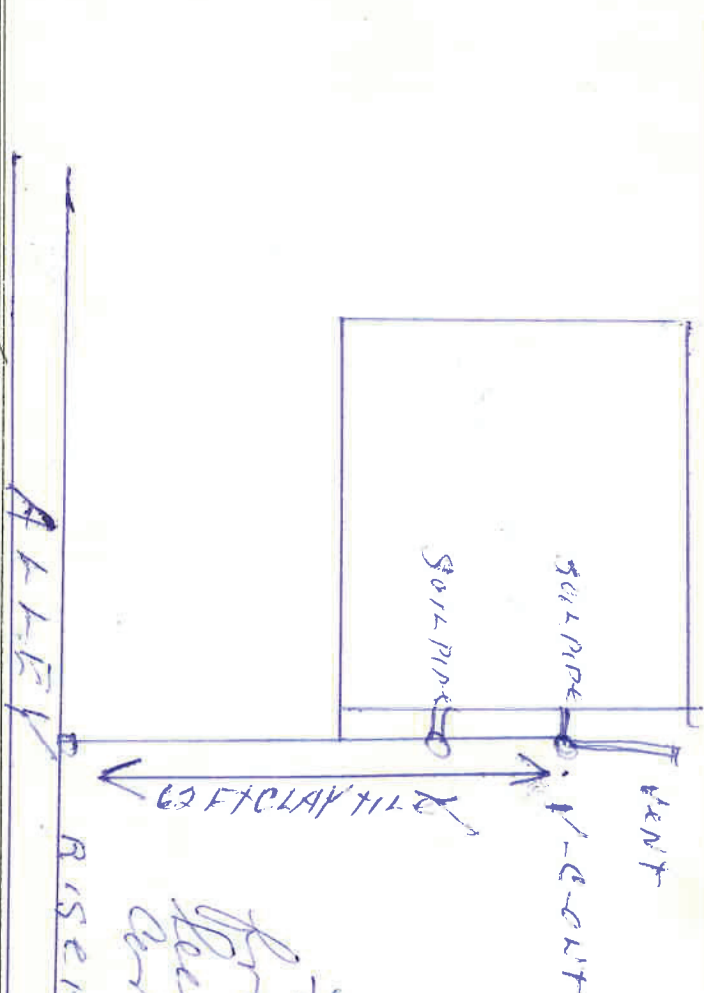

From the riser to the vent  
 from corner of house to the  
 riser - note feet from same  
 corner - note to check out  
 13 inches deep

02-5800.0

1. Commercial..... Single Residence..... Multiple Dwelling..... joint Use.....
2. Distance from property line to sewer line.....
3. Distance from house building line to property line..... From property line to bldg. 200
4. Min. grade from main to property line.....
5. Distance from M. H. No. ....
6. Depth: Sewer main.....
7. Basement..... Basement connection.....
8. Depth of pipe at house connection..... Vitrified Clay..... (Reference to first floor)  
 Asbestos-Cement..... Size 11/4
9. Type of pipe: Concrete..... Vitrified Clay..... Asbestos-Cement..... Size.....
10. Remarks: .....

### COMMERCIAL ONLY

1. Name .....
2. Type .....
3. Sq. Ft. Floor Space .....
4. No. of Floors .....
5. Remarks: .....

### SPECIAL AGREEMENTS

1. Grade Release .....
2. High Grade Release .....
3. Non-Protecting Agmt. ....
4. Easement .....
5. Permission to Connect .....
6. Special .....

I hereby certify that the above connection has been made as shown:

Inspector Henry J. Gaudin Date 1/15/60  
 Date Permit Issued..... Permit No. 151