

CASCADE VALLEY HOSPITAL AND CLINICS

MASTERPLAN EXPANSION PROJECT

AS-BUILT SITE CIVIL DOCUMENTS

CITY PROJECT NO. PWD 20080071

PROJECT TEAM

OWNER:
 CASCADE VALLEY HOSPITAL AND CLINICS
 330 STILLAGUAMISH AVENUE
 ARLINGTON, WA 98223
 CONTACT: CONNIE DIGREGORIO
 INTERNAL PROJECT MANAGER
 PHONE: (360) 435-2133
 VOICE: (360) 618-7806
 CELL: (425) 268-2300
 FAX: (360) 435-0513
 connied@cascadvalley.org

OWNER'S REPRESENTATIVE:
 RITTER CONSTRUCTION MANAGEMENT, INC.
 1448 MT. BAKER HIGHWAY
 BELLINGHAM, WA 98225
 CONTACT: ANDREAS AALHUS, PRINCIPAL
 PHONE: (604) 924-3183
 CELL: (604) 230-0560
 FAX: (866) 778-7751
 aaalhus@rcmci.com

CONTACT: JOHN JONES,
 ON SITE PROJECT MANAGER
 PHONE: (360) 201-5505
 john@rcmci.net

ARCHITECT:
 TAYLOR GREGORY BUTTERFIELD ARCHITECTS
 21911 76TH AVE W, SUITE 210
 EDMONDS, WA 98026
 CONTACT: LOIS BROADWAY
 TIM SADLER
 SHELL/CORE PROJECT LEAD
 PHONE: (425) 778-1530
 CELL: (206) 850-9682
 FAX: (425) 774-7803
 lbroadway@tgbarchitects.com

GENERAL CONTRACTOR/CONSTRUCTION MANAGER:
 HOFFMAN CONSTRUCTION COMPANY
 1505 WESTLAKE AVENUE N, SUITE 500
 SEATTLE, WA 98108
 CONTACT: BILL FORSYTHE,
 PROJECT MANAGER, PRECON
 DARHL EDWARDS, ESTIMATOR
 PHONE: (206) 286-6697
 FAX: (206) 286-7523
 Bill-Forsythe@hoffmancorp.com

CIVIL ENGINEER:
 KPFF CONSULTING ENGINEERS
 1601 FIFTH AVENUE, SUITE 1600
 SEATTLE, WA 98199
 CONTACT: JORDAN BROWN
 PHONE: (206) 622-5822
 FAX: (206) 622-8130
 jordan.brown@kpff.com

STRUCTURAL ENGINEER:
 DEGENKOLB ENGINEERS
 800 UNIVERSITY STREET
 SEATTLE, WA 98101
 CONTACT: DAVID GONZALEZ,
 ASSOCIATE PRINCIPAL/
 PROJECT MANAGER
 PHONE: (206) 262-9240
 FAX: (206) 262-9346
 dgonzalez@degenkolb.com

MECHANICAL ENGINEER:
 HARGIS ENGINEERS
 600 STEWART STREET, SUITE 1000
 SEATTLE, WA 98101
 CONTACT: RON ELIASON, ASSOCIATE
 PHONE: (206) 448-3376
 CELL: (206) 963-5682
 FAX: (206) 448-4850
 rone@hargis.biz

LANDSCAPE ARCHITECT:
 BRUMBAUGH & ASSOCIATES
 600 NORTH 85TH STREET, SUITE 102
 SEATTLE, WA 98103-3826
 CONTACT: KRISTEN LUNDQUIST
 PHONE: (206) 782-3650
 FAX: (206) 782-3675
 KristenL@brumbaugh-assoc.com

ABBREVIATIONS

AC	ASPHALT CONCRETE/ASBESTOS CEMENT	MH	MANHOLE
ADD'L	ADDITIONAL	MIN	MINIMUM
ASSY	ASSEMBLY	MJ	MECHANICAL JOINT
ATB	ASPHALT TREATED BASE	N	NORTH/NORTHING
B	BEND	NO / #	NUMBER
BC	BOTTOM OF CURB	NTS	NOT TO SCALE
B/C	BACK OF CURB	O.C.	ON CENTER
BLDG	BUILDING	PC	POINT OF CURVATURE
B/W	BACK OF WALK	PCC	PORTLAND CEMENT CONCRETE
CB	CATCH BASIN	PIV	POST INDICATOR VALVE
CFS	CUBIC FEET PER SECOND	PL	PROPERTY LINE
CL	CENTERLINE	POC	POINT OF CONNECTION
CL 52	CLASS 52	PROP	PROPOSED
CO	CLEANOUT	PT	POINT OF TANGENCY
COA	CITY OF ARLINGTON	PVC	POLYVINYL CHLORIDE
CONC	CONCRETE	R	RADIUS
CTV	CABLE TELEVISION	ROW	RIGHT-OF-WAY
CU YD	CUBIC YARD	RT	RIGHT
D	DELTA	S	SOUTH
DCVA	DETECTOR CHECK VALVE ASSEMBLY	SD	STORM DRAIN
DI	DUCTILE IRON	SDMH	STORM DRAIN MANHOLE
DIA	DIAMETER	SNOPUD	SNOHOMISH COUNTY PUD
DOM	DOMESTIC	SQ FT	SQUARE FEET
DTL	DETAIL	SS	SANITARY SEWER
E	EAST/EASTING	SSD	SANITARY SEWER DRAIN
EL	ELEVATION	STA	STATION
EX / EXIST	EXISTING	STD	STANDARD
FCS	FLOW CONTROL STRUCTURE	S/W	SIDEWALK
FDC	FIRE DEPARTMENT CONNECTION	TB	THRUST BLOCK
FF	FINISH FLOOR	TC	TOP OF CURB
FH	FIRE HYDRANT	TESC	TEMPORARY EROSION AND SEDIMENTATION CONTROL
FJ	FLANGE JOINT	TYP	TYPICAL
F/C	FACE OF CURB	VAC	VACUUM
F/L	FLOWLINE	W	WEST
FL	FLANGE	WL	WATER LINE
FNDN	FOUNDATION	WQ	WATER QUALITY
GV	GATE VALVE	W/	WITH
GW	GREASE WASTE	WSDOT	WASHINGTON STATE DEPARTMENT OF TRANSPORTATION
HORIZ	HORIZONTAL	X-INGS	CROSSINGS
HYD	HYDRANT	&	AND
IE	INVERT ELEVATION	⊙	AT
INFO	INFORMATION		
IL	ILLUMINATION		
L	LENGTH		
LF	LINEAL FEET		
LT	LEFT		
MAX	MAXIMUM		
MECH	MECHANICAL		

LEGEND

	ASPHALT PAVEMENT
	CONCRETE PAVEMENT
	PROPERTY LINE
	GRADE BREAK
	ROADWAY CENTERLINE
	SAWCUT LINE
	ELECTRIC UTILITY
	GAS UTILITY
	SANITARY SEWER
	STORM DRAIN
	WATER
	FOUNDATION DRAINAGE
	AREA DRAIN
	CLEANOUT
	CATCH BASIN OR INLET
	FIRE HYDRANT
	FLOW CONTROL STRUCTURE
	GENERAL DRAINAGE FLOW PATH
	CATCH BASIN OR MANHOLE
	SPOT GRADE (AT FINISHED GRADE)
	SPEED BUMP (ASPHALT)
	SLOPE OF FINISHED GRADE

SITE LOCATION

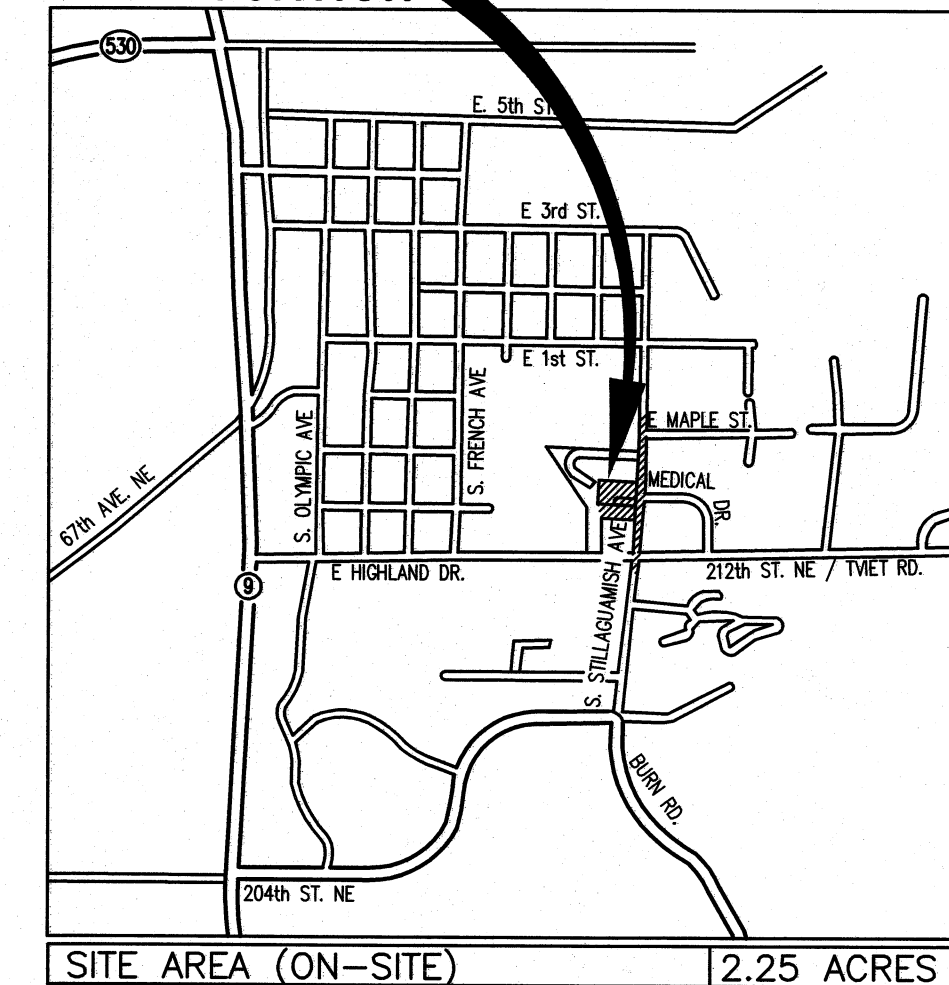

VICINITY MAP

SCALE 1"=300'

DRAWING INDEX

SHEET NO.	DRAWING TITLE
C1.0	COVER SHEET
C1.1	GENERAL NOTES NOT INCLUDED
C1.21-C1.29	PROJECT SURVEY NOT INCLUDED
C2.0	PHASING AND TEST PLAN NOT INCLUDED
C2.1	MASS EXCAVATION AND DEMOLITION PLAN - PHASE 1 NOT INCLUDED
C2.2	MASS EXCAVATION AND DEMOLITION PLAN - PHASE 2 NOT INCLUDED
C3.0	HORIZONTAL CONTROL PLAN
C4.0	GRADING AND DRAINAGE PLAN
C4.1	STORM DRAINAGE PROFILES
C4.2	DRAINAGE SECTIONS AND DETAILS NOT INCLUDED
C5.0	UTILITIES INFRASTRUCTURE PLAN
C5.1	SANITARY SEWER PROFILE
C6.1	WATER MAIN REPLACEMENT PLAN AND PROFILE
C6.2	WATER MAIN REPLACEMENT PLAN AND PROFILE
C6.3	WATER MAIN REPLACEMENT PLAN AND PROFILE
C7.1	UTILITY DETAILS NOT INCLUDED
C7.2	UTILITY DETAILS NOT INCLUDED
C7.3	UTILITY DETAILS NOT INCLUDED
C7.4	UTILITY DETAILS NOT INCLUDED
E1.00	ELECTRICAL DEMOLITION SITE PLAN NOT INCLUDED
E1.01	ELECTRICAL SITE UTILITY PLAN NOT INCLUDED
E1.02	ELECTRICAL SITE LIGHTING AND POWER PLAN NOT INCLUDED
L1.0	LANDSCAPE PLAN NOT INCLUDED
L1.1	LANDSCAPE ENLARGEMENT PLAN NOT INCLUDED
L1.2	LANDSCAPE SCHEDULE AND DETAILS NOT INCLUDED
L1.3	LAYOUT PLAN NOT INCLUDED
L1.4	IRRIGATION PLAN NOT INCLUDED

AS-BUILT DRAWING APPROVAL ACKNOWLEDGMENT

THIS AS-BUILT PLAN HAS BEEN REVIEWED AND ACCEPTED AS A RECORD DRAWING. THE LICENSED ENGINEER WHOSE STAMP AND SIGNATURE APPEAR ON THIS SHEET ASSUMES FULL AND COMPLETE ACCURACY THEREIN. SEE RECORD DRAWING NOTE.

By:
 City Engineer, City of Arlington
 DATE: 6/12/2012

tgb | taylor gregory butterfield architects

1 425.778.1530 21911 76th Ave W, Suite 210
 425.774.7803 Edmonds WA 98026
 info@tgbarchitects.com
 www.tgbarchitects.com

RECORD DRAWINGS
 THESE RECORD DOCUMENTS HAVE BEEN PREPARED FROM THE CONTRACTOR'S TOPOGRAPHIC SURVEY AND RED-LINED MARK-UPS OF THE CONSTRUCTION DOCUMENTS. THE ENGINEER OF RECORD SIGNING THESE RECORD DRAWINGS HAS NOT WITNESSED ALL ELEMENTS OF CONSTRUCTION AND IS NOT RESPONSIBLE FOR ERRORS OR OMISSIONS IN DATA PROVIDED BY THE CONTRACTOR'S REDLINES.

CALL TWO BUSINESS DAYS BEFORE YOU DIG
 1-800-424-5555

kpff Consulting Engineers
 1601 Fifth Avenue, Suite 1600
 Seattle, Washington 98101-3665
 (206) 622-5822 Fax (206) 622-8130



CASCADE VALLEY HOSPITAL & CLINICS
 330 S. STILLAGUAMISH AVE., ARLINGTON, WA

COVER SHEET

SHEET

C1.0

NO.	DATE	BY	CHD.	APPR.	REVISION
1	12/8/11	JRB	JRB	N/A	AS-BUILT RECORD DRAWINGS

DRAWN BY	DESIGNED BY
PE/TAL	JRB/KPK
CHECKED BY	APPROVED BY
JRB	MAV
DATE	
8/13/2008	
J O B No. : 107369	

S C A L E :
 N.T.S.

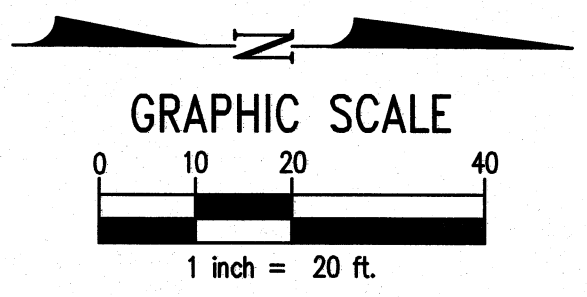
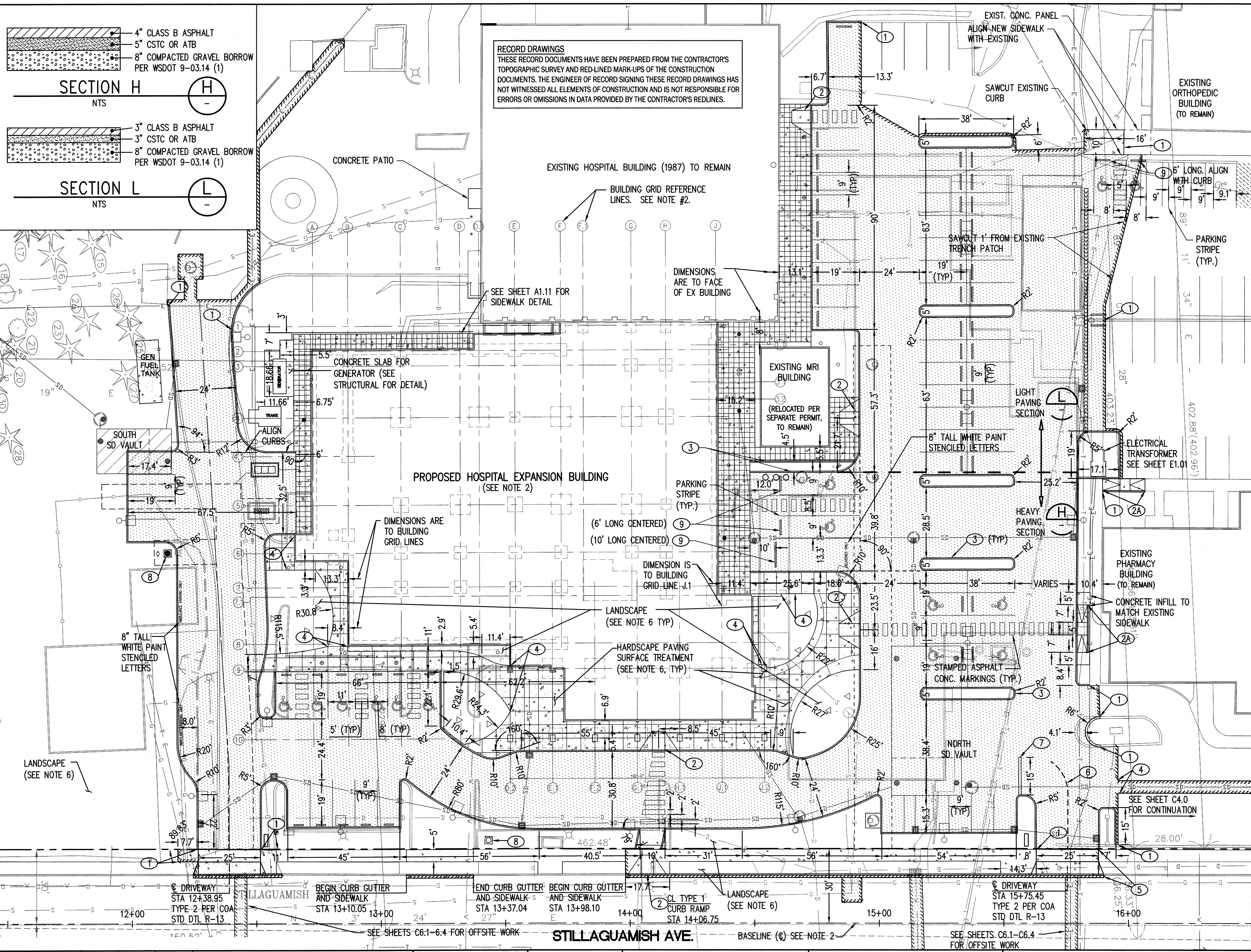

- LEGEND**
- ASPHALT PAVEMENT (SEE TOP LEFT CORNER OF THIS SHEET)
 - CONCRETE PAVEMENT (4" PCC 3000 PSI OVER 4" CSTC)
 - HYDROSEED
 - PAVEMENT SECTION DIVIDING LINE
 - SAWCUT
 - CROSSWALK PAVEMENT MARKINGS (PER ARCH SITEPLAN)
 - 3' PEDESTRIAN LIGHT (PER ELECTRICAL PLAN)
 - 12' LIGHT STANDARD (PER ELECTRICAL PLAN)
- NOTE:**
- THIS HORIZONTAL CONTROL PLAN IS INTENDED FOR LAYOUT OF CURBS, ASPHALT PAVEMENT, AND SIDEWALK PAVING AND RELATED TO EXTERIOR OF BUILDINGS AND DRIVEWAY CENTERLINES. SEE UTILITY PLANS FOR HORIZONTAL CONTROL OF UTILITIES AND EASEMENTS. SEE SHEETS C6.1-C6.2 FOR HORIZONTAL CONTROL OF STILLAGUAMISH BASELINE (CENTERLINE). STILLAGUAMISH AVENUE CENTERLINE NOT PARALLEL TO BUILDINGS.
 - SEE ARCHITECTURAL AND STRUCTURAL PLANS (S2.0) FOR HORIZONTAL CONTROL OF BUILDING AND GRID.
 - SEE SURVEY SHEETS FOR BENCH MARKS, PROPERTY LINES, CENTERLINE AND BASELINES.
 - ALL CONSTRUCTION SHALL CONFORM TO CITY OF ARLINGTON STANDARDS DETAILS AND SPECIFICATIONS.
 - SEE SHEETS C6.1-6.3 FOR OFFSITE WORK.
 - SEE LANDSCAPE SHEETS FOR LANDSCAPE WORK, PAVING SURFACE TREATMENT AND PAVING SCORING/JOINTING.
 - SEE SHEETS A1.10 & A1.11 FOR ADDITIONAL SITE FEATURES AND DETAILS.
- CONSTRUCTION NOTES:**
- MATCH EXISTING
 - TYPE 1 CURB RAMP PER WSDOT STD PLAN F-40.10-01
 - PARALLEL CURB RAMP PER WSDOT STD PLAN F-40.12-01
 - CEMENT CONCRETE TRAFFIC CURB PER WSDOT STD PLAN F-10.12-00
 - ALIGN WITH PROPOSED CURB OR BUILDING ELEMENT AS SHOWN
 - SIDEWALK AND CURB RESTORATION AT EXISTING DRIVEWAYS PER COA REQUIREMENTS
 - YELLOW TRAFFIC STRIPE (4" WIDE, 24" LONG, 24" SPACING)
 - 12" WIDE STOP BAR (THERMOPLASTIC) AND STOP SIGN PER MUTCD STD
 - 3'x3' CONCRETE PAD PER COA STD DTL W-02
 - WHEEL STOP PER A1.11, DETAIL 5, 4' LONG

- CONSTRUCTION NOTES:**
- MATCH EXISTING
 - TYPE 1 CURB RAMP PER WSDOT STD PLAN F-40.10-01
 - PARALLEL CURB RAMP PER WSDOT STD PLAN F-40.12-01
 - CEMENT CONCRETE TRAFFIC CURB PER WSDOT STD PLAN F-10.12-00
 - ALIGN WITH PROPOSED CURB OR BUILDING ELEMENT AS SHOWN
 - SIDEWALK AND CURB RESTORATION AT EXISTING DRIVEWAYS PER COA REQUIREMENTS
 - YELLOW TRAFFIC STRIPE (4" WIDE, 24" LONG, 24" SPACING)
 - 12" WIDE STOP BAR (THERMOPLASTIC) AND STOP SIGN PER MUTCD STD
 - 3'x3' CONCRETE PAD PER COA STD DTL W-02
 - WHEEL STOP PER A1.11, DETAIL 5, 4' LONG

- CONSTRUCTION NOTES:**
- MATCH EXISTING
 - TYPE 1 CURB RAMP PER WSDOT STD PLAN F-40.10-01
 - PARALLEL CURB RAMP PER WSDOT STD PLAN F-40.12-01
 - CEMENT CONCRETE TRAFFIC CURB PER WSDOT STD PLAN F-10.12-00
 - ALIGN WITH PROPOSED CURB OR BUILDING ELEMENT AS SHOWN
 - SIDEWALK AND CURB RESTORATION AT EXISTING DRIVEWAYS PER COA REQUIREMENTS
 - YELLOW TRAFFIC STRIPE (4" WIDE, 24" LONG, 24" SPACING)
 - 12" WIDE STOP BAR (THERMOPLASTIC) AND STOP SIGN PER MUTCD STD
 - 3'x3' CONCRETE PAD PER COA STD DTL W-02
 - WHEEL STOP PER A1.11, DETAIL 5, 4' LONG

AS-BUILT DRAWING APPROVAL

THIS PLAN SHEET HAS BEEN REVIEWED AND APPROVED PER THE CONDITIONS ON THE TITLE SHEET.

BY: *Eve Acott*
City Engineer, CITY OF ARLINGTON

DATE: 6/12/2012

NO.	DATE	BY	CHD.	APPR.	REVISION
12	12/8/11	JRB	JRB	N/A	AS-BUILT RECORD DRAWINGS
11	12/16/10	JRB	JRB	MAV	NORTH PARKING REVISIONS (RFI 826)
10	10/04/10	JRB	JRB	MAV	SOUTH DRIVE - CCD 078.1
9	9/17/10	JRB	JRB	JRB	NORTH PARKING - RFI 757
8	9/16/10	JRB	JRB	JRB	SOUTH DRIVE - CCD 078

DRAWN BY PE/TAL
DESIGNED BY JRB/KPK
CHECKED BY JRB
APPROVED BY MAV

DATE 8/13/2008

JOB No.: 107369

CALL TWO BUSINESS DAYS BEFORE YOU DIG 1-800-424-5555

kpfi Consulting Engineers
1601 Fifth Avenue, Suite 1600
Seattle, Washington 98101-3665
(206) 622-5822 Fax (206) 622-8130

SCALE: AS NOTED

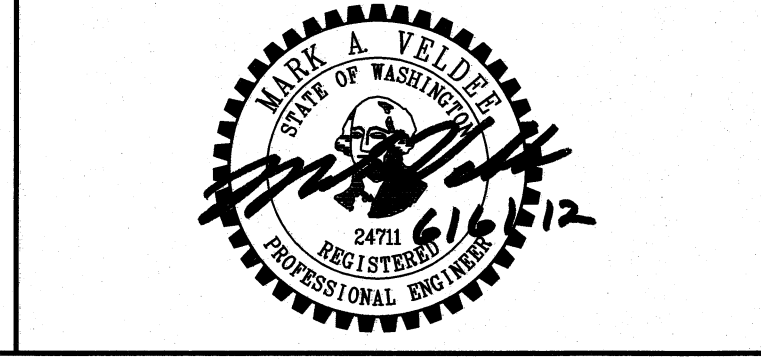

CASCADE VALLEY HOSPITAL & CLINICS
330 S. STILLAGUAMISH AVE., ARLINGTON, WA

ON-SITE IMPROVEMENTS HORIZONTAL CONTROL PLAN

SHEET C3.0

Jun 06, 2012 - 8:41am
 jordanb
 X:\107251-107500\107500\Cascade Valley Hosp\CAD\Design\As-Built\CVH-CO-C3.0-HC.dwg

RECORD DRAWINGS
 THESE RECORD DOCUMENTS HAVE BEEN PREPARED FROM THE CONTRACTOR'S TOPOGRAPHIC SURVEY AND RED-LINED MARK-UPS OF THE CONSTRUCTION DOCUMENTS. THE ENGINEER OF RECORD SIGNING THESE RECORD DRAWINGS HAS NOT WITNESSED ALL ELEMENTS OF CONSTRUCTION AND IS NOT RESPONSIBLE FOR ERRORS OR OMISSIONS IN DATA PROVIDED BY THE CONTRACTOR'S REDLINES.

AS-BUILT DRAWING APPROVAL
 THIS PLAN SHEET HAS BEEN REVIEWED AND APPROVED PER THE CONDITIONS ON THE TITLE SHEET.
 BY: *[Signature]*
 City Engineer, CITY OF ARLINGTON
 DATE: 6/12/2012

- PHASING NOTES:**
- FOUNDATION DRAINAGE AND ROOF RUNOFF FROM NEW BUILDING SHALL BE TEMPORARILY PUMPED TO STORM DRAINAGE SYSTEM IN STILLAGUAMISH AVE BETWEEN CATCH BASINS SHOWN PRIOR TO DEMOLITION OF EXISTING BUILDING AND COMPLETION OF ON-SITE STORM DRAINAGE SYSTEM. ROUTING SHALL BE FLEXIBLE AND SHALL BE DETERMINED BY THE CONTRACTOR. SEE SHEET C2.0 FOR SIZING.
 - PROVIDE TEMPORARY STORM DRAINAGE CONNECTION BETWEEN CATCH BASINS SHOWN FOR DISCHARGE OF FOUNDATION DRAINAGE AND ROOF STORMWATER FROM NEW BUILDING TO STORM DRAINAGE SYSTEM IN STILLAGUAMISH AVE PRIOR TO DEMOLITION OF EXISTING BUILDING AND COMPLETION OF ON-SITE STORM DRAINAGE SYSTEM. PLUG TEMPORARY LINE FROM BOTH ENDS UPON COMPLETION OF ON-SITE SYSTEM.

- GRADING NOTES:**
- HARDSCAPE SHALL SLOPE BETWEEN SPOT GRADES AT CONSTANT SLOPE.
 - WHEN GRADES CALL TO MATCH EXISTING, SPOT GRADES SHOWN ARE APPROXIMATE.
 - MATCH EXISTING GRADE AT ALL SAWCUT LINES.
 - CONTRACTOR SHALL PROTECT INLETS FROM SILTATION. SEE TESC SHEETS FOR INLET PROTECTION.
 - MINIMUM CROSS SLOPE FOR PARKING LOT SHALL BE 2%.

- DRAINAGE NOTES:**
- CATCH BASINS AND INLETS ARE PER COA STANDARD PLANS, LATEST EDITION.
 - DETENTION/WQ VAULTS ARE PRECAST BY UTILITY VAULT. SEE SHEET C4.2 FOR DETAILS.
 - INSTALL CATCH BASINS TO FACILITATE TESC PER SHEET C2.0.
 - CATCH BASIN GRATES ARE ALIGNED WITH AND ADJACENT TO CURB UNLESS OTHERWISE SPECIFIED.
 - DIMENSIONS ARE MEASURED TO CENTER OF CATCH BASINS.

- CONSTRUCTION NOTES:**
- CURB HEIGHT VARIES BETWEEN SPOT GRADES.
 - ALIGN VAULT WITH CURB.
 - DURING TRENCHING OPERATIONS IN THIS AREA, CONTRACTOR SHALL MINIMIZE DISTURBANCE TO EXISTING ROOTS BY EXCAVATING BY HAND OR ARRANGE FOR OBSERVATION DURING TRENCHING AFTER ROOTS HAVE BEEN EXPOSED AND PROTECTED. ROOTS THAT CROSS THE TRENCH ALIGNMENT ARE TO REMAIN, UNLESS DIRECTED OTHERWISE BY OWNER'S REPRESENTATIVE. INSTALL STORM DRAIN LINE BELOW THE EXISTING ROOTS. CONTRACTOR SHALL EXPOSE THE ROOT SYSTEM AND COORDINATE PROTECTION MEASURES WITH ENGINEER, LANDSCAPE ARCHITECT, AND OWNER'S REPRESENTATIVE FOUR (4) WORKING DAYS PRIOR TO EXCAVATION IN THIS AREA. ROOTS IMPACTED DURING EXCAVATION SHALL BE CLEAN OUT AND SEALED. SEE LANDSCAPE PLANS FOR ADDITIONAL INFORMATION.

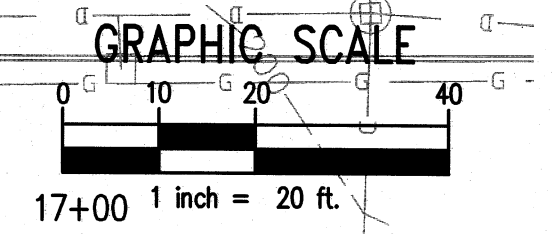
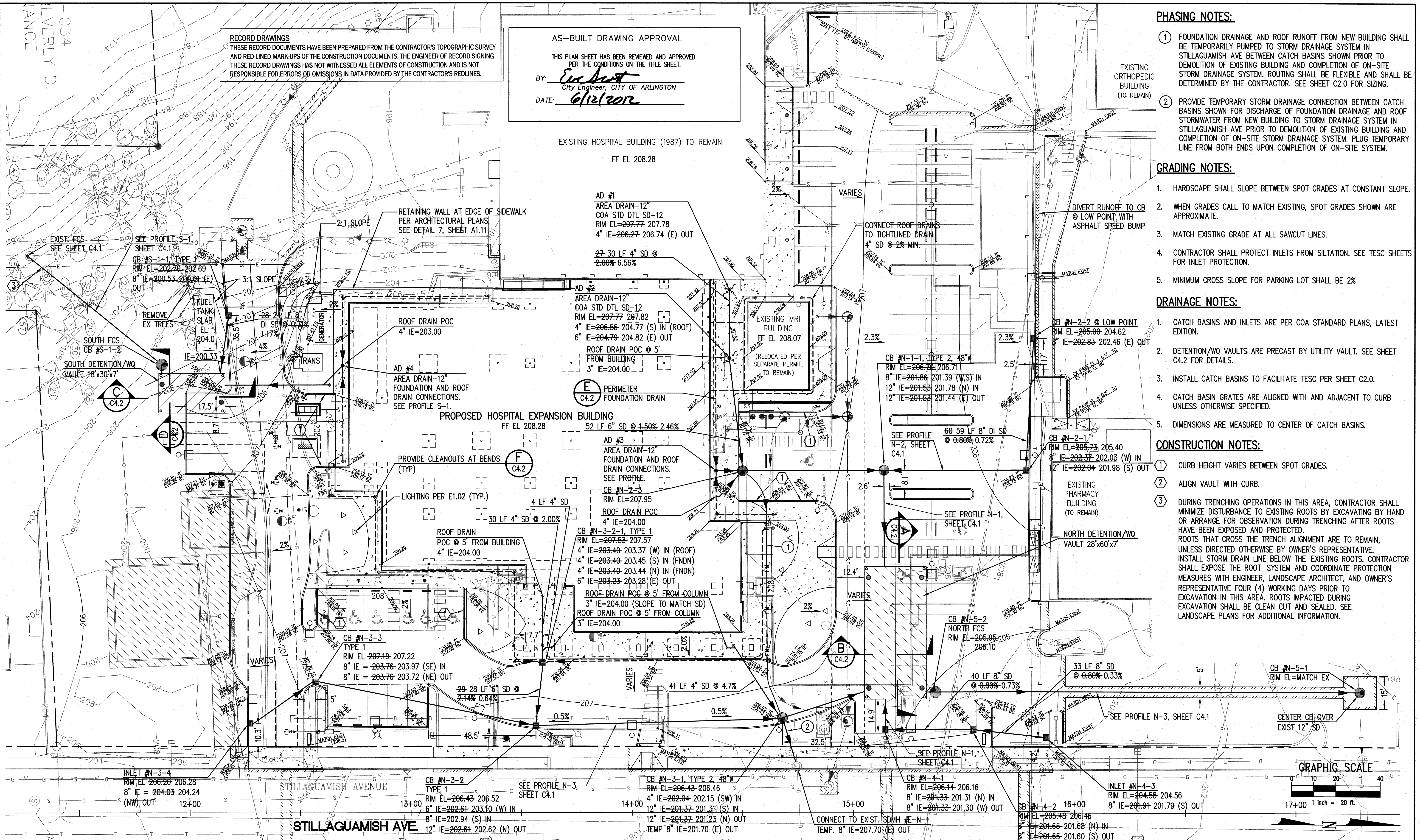

11	12/8/11	JRB	JRB	N/A	AS-BUILT RECORD DRAWINGS
10	12/16/10	JRB	JRB	MAV	NORTH PARKING REVISIONS (RFI 826)
9	10/04/10	JRB	JRB	MAV	SOUTH DRIVE CCD 078.1
8	9/21/10	JRB	JRB	JRB	ROTATE NORTH VAULT
7	9/17/10	JRB	JRB	JRB	CATCH BASIN SHIFT RFI 757
NO.	DATE	BY	CHD.	APPR.	REVISION

DRAWN BY PE/TAL
 DESIGNED BY JRB/KPK
 CHECKED BY JRB
 APPROVED BY MAV
 DATE 8/13/2008
 J O B No. : 107369

CALL TWO BUSINESS DAYS BEFORE YOU DIG 1-800-424-5555

kpff Consulting Engineers
 1601 Fifth Avenue, Suite 1600
 Seattle, Washington 98101-3665
 (206) 622-5822 Fax (206) 622-8130

SCALE: AS NOTED



CASCADE VALLEY HOSPITAL & CLINICS
 330 S. STILLAGUAMISH AVE., ARLINGTON, WA
ON-SITE IMPROVEMENTS
GRADING AND DRAINAGE PLAN

SHEET
C4.0

X:\107251-1075001\107369 (Cascade Valley Hosp) CAD\Design\As-Built\CH-C4.0-C4.0-GD.dwg
 Jun 06, 2012 - 8:41 am
 jordanb

NOTES:

1. PROFILES SHOW CATCH BASIN SIZES, RIM ELEVATIONS, INVERT ELEVATIONS, PIPE LENGTHS, PIPE SIZES, PIPE SLOPES, PROPOSED GRADES AND EXISTING GRADES ALONG MAJOR STORM DRAIN RUNS.
2. HORIZONTAL CONTROL OF CATCH BASINS IS PROVIDED ON SHEET C4.0.
3. DETAILS FOR CATCH BASINS AND PIPES NOT LOCATED ALONG THESE PROFILES ARE INCLUDED ON SHEET C4.0.

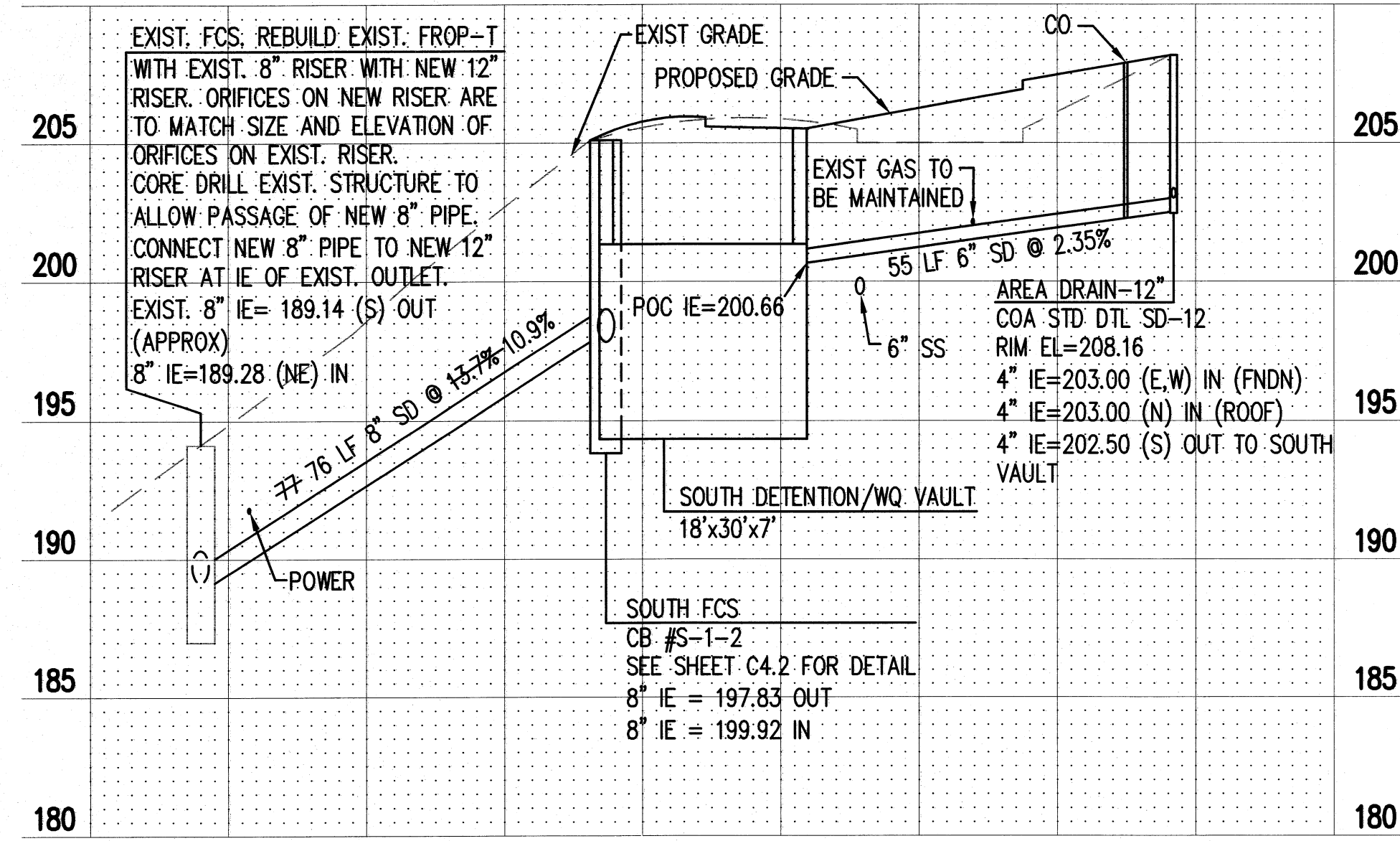

STORM DRAINAGE PROFILE S-1

FACING WEST

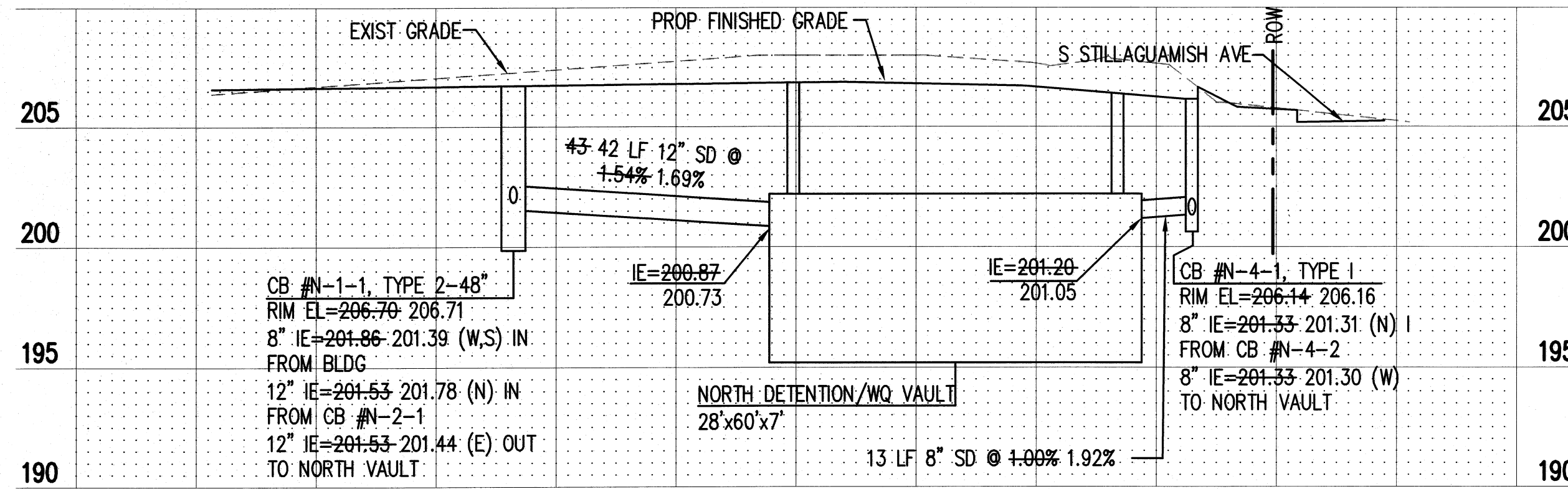

STORM DRAINAGE PROFILE N-1

FACING NORTH

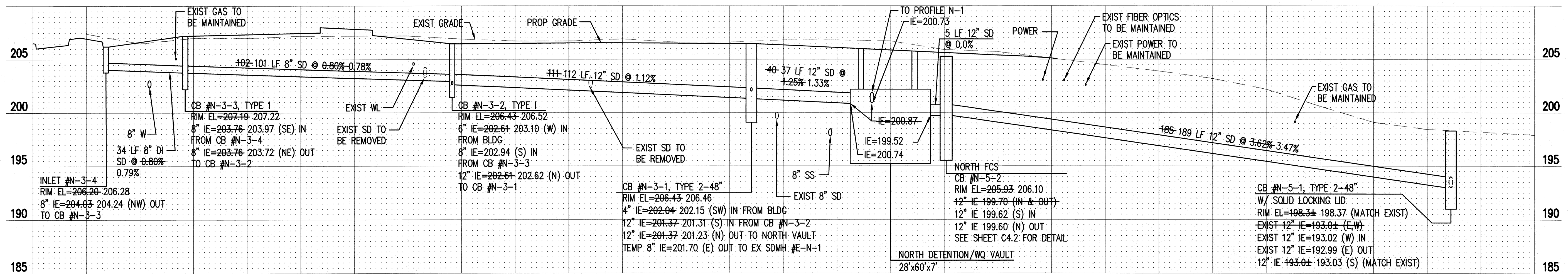

STORM DRAINAGE PROFILE N-3

FACING WEST

RECORD DRAWINGS
 THESE RECORD DOCUMENTS HAVE BEEN PREPARED FROM THE CONTRACTOR'S TOPOGRAPHIC SURVEY AND RED-LINED MARK-UPS OF THE CONSTRUCTION DOCUMENTS. THE ENGINEER OF RECORD SIGNING THESE RECORD DRAWINGS HAS NOT WITNESSED ALL ELEMENTS OF CONSTRUCTION AND IS NOT RESPONSIBLE FOR ERRORS OR OMISSIONS IN DATA PROVIDED BY THE CONTRACTOR'S REDLINES.

AS-BUILT DRAWING APPROVAL
 THIS PLAN SHEET HAS BEEN REVIEWED AND APPROVED PER THE CONDITIONS ON THE TITLE SHEET.
 BY: *Eric Saut*
 City Engineer, CITY OF ARLINGTON
 DATE: 6/12/2012

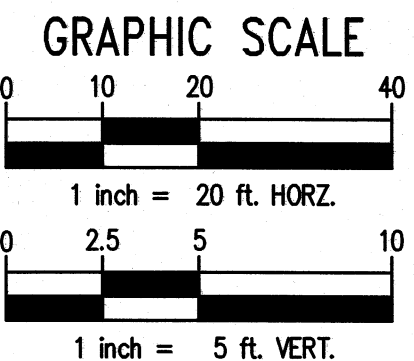

X:\107251-107500\107369 (Cascade Valley Hosp)\CAD\Design\As-Built\CD-C4-C4.1-SD PRO.dwg
 jordanb
 Jun 06, 2012 - 8:46am

NO.	DATE	BY	CHD.	APPR.	REVISION
3	12/8/11	JRB	JRB	N/A	AS-BUILT RECORD DRAWINGS
2	9/21/10	JRB	JRB	JRB	ROTATE NORTH VAULT
1	5/19/10	JRB	JRB	JRB	SOUTH DRIVE TURNAROUND

DRAWN BY PE/TAL	DESIGNED BY JRB/KPK
CHECKED BY JRB	APPROVED BY MAV
DATE 8/13/2008	
JOB No.: 107369	

CALL TWO BUSINESS DAYS BEFORE YOU DIG
 1-800-424-5555

SCALE:
AS NOTED

kpf Consulting Engineers
 1601 Fifth Avenue, Suite 1600
 Seattle, Washington 98101-3665
 (206) 622-5822 Fax (206) 622-8130

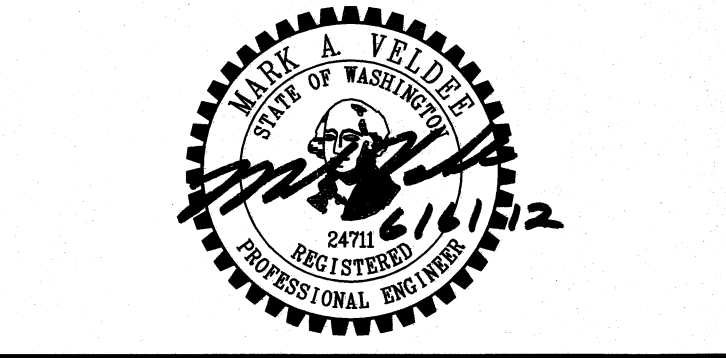

CASCADE VALLEY HOSPITAL & CLINICS
 330 S. STILLAGUAMISH AVE., ARLINGTON, WA

ON-SITE IMPROVEMENTS
STORM DRAINAGE PROFILES

SHEET
C4.1

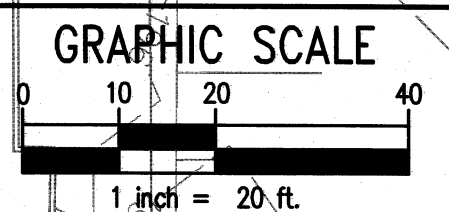

RECORD DRAWINGS
 THESE RECORD DOCUMENTS HAVE BEEN PREPARED FROM THE CONTRACTOR'S TOPOGRAPHIC SURVEY AND RED-LINED MARK-UPS OF THE CONSTRUCTION DOCUMENTS. THE ENGINEER OF RECORD SIGNING THESE RECORD DRAWINGS HAS NOT WITNESSED ALL ELEMENTS OF CONSTRUCTION AND IS NOT RESPONSIBLE FOR ERRORS OR OMISSIONS IN DATA PROVIDED BY THE CONTRACTOR'S REDLINES.

AS-BUILT DRAWING APPROVAL
 THIS PLAN SHEET HAS BEEN REVIEWED AND APPROVED PER THE CONDITIONS ON THE TITLE SHEET.
 BY: *Eric Swart*
 Senior Engineer, CITY OF ARLINGTON
 DATE: 6/12/2012

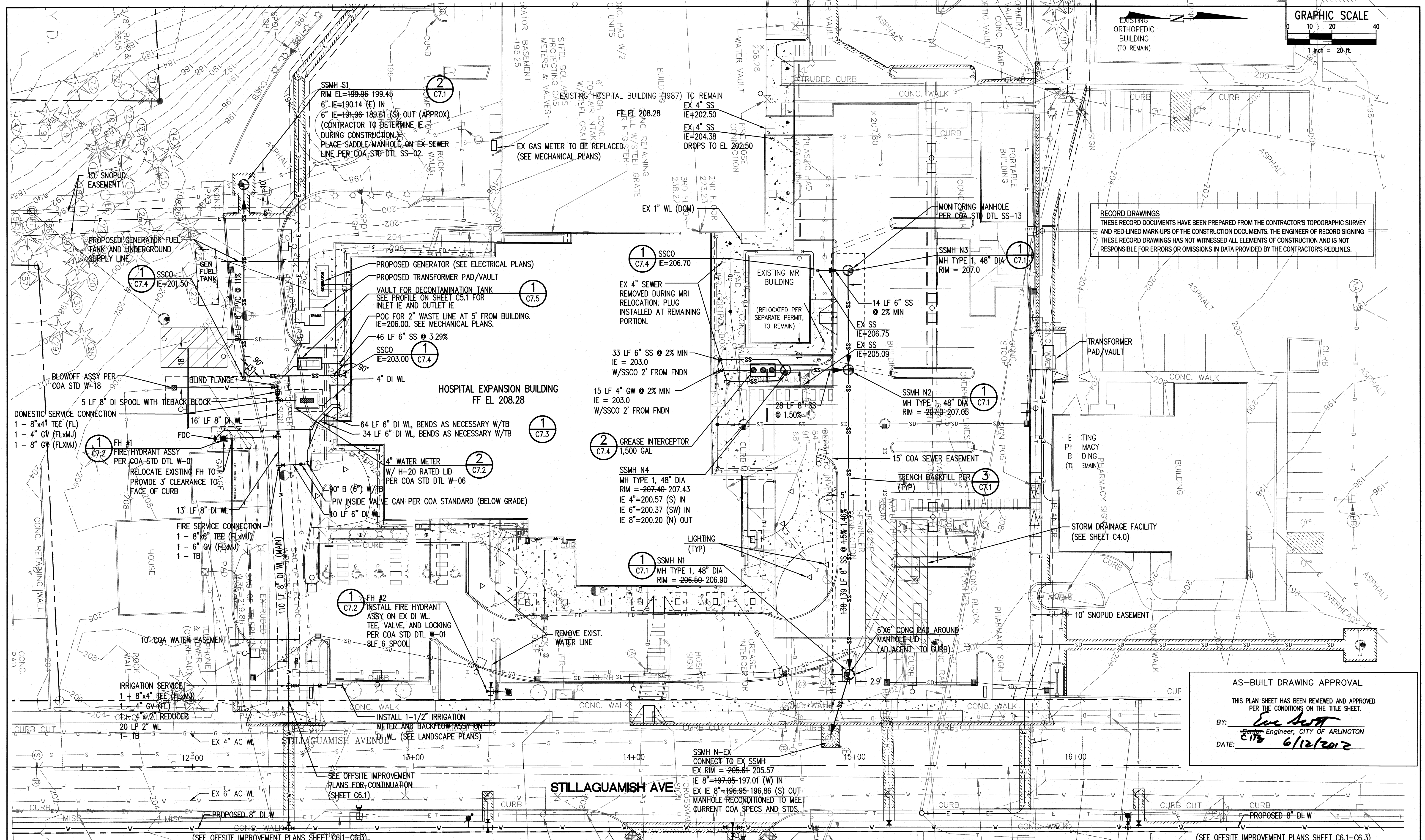

NO.	DATE	BY	CHD.	APPR.	REVISION
9	12/8/11	JRB	JRB	N/A	AS-BUILT RECORD DRAWINGS
8	10/1/10	JRB	JRB	MAV	SOUTH DRIVE, MOVE HYD (CCD 078.1)
7	5/11/09	JRB	JRB	MAV	REMOVE PROPOSED UTILITIES FOR CONFERENCE ROOM
6	3/17/09	JRB	JRB	MAV	SOUTH DRIVE REALIGNMENT - MOVE FDC
5	10/27/08	KPK	KPK	MAV	RFI 56 - VAULT FOR DECONTAMINATION TANK

DRAWN BY: PE/TAL
 DESIGNED BY: JRB/KPK
 CHECKED BY: JRB
 APPROVED BY: MAV
 DATE: 8/13/2008
 J O B No. : 107369

CALL TWO BUSINESS DAYS BEFORE YOU DIG 1-800-424-5555
 SCALE: AS NOTED

kpf Consulting Engineers
 1601 Fifth Avenue, Suite 1600
 Seattle, Washington 98101-3665
 (206) 622-5822 Fax (206) 622-8130

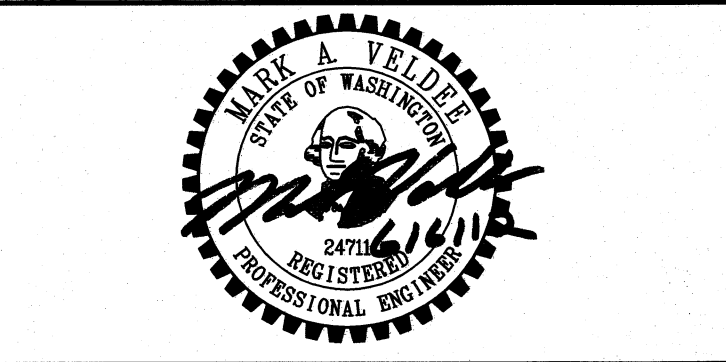

CASCADE VALLEY HOSPITAL & CLINICS
 330 S. STILLAGUAMISH AVE., ARLINGTON, WA
ON-SITE IMPROVEMENTS UTILITIES INFRASTRUCTURE PLAN
 SHEET C5.0

Jun 06, 2012 - 8:52am
 X:\107251-107500\107500 (Cascade Valley Hosp) CAD (Design) - builds - builds - CHA-CP-C5.0-UT.dwg

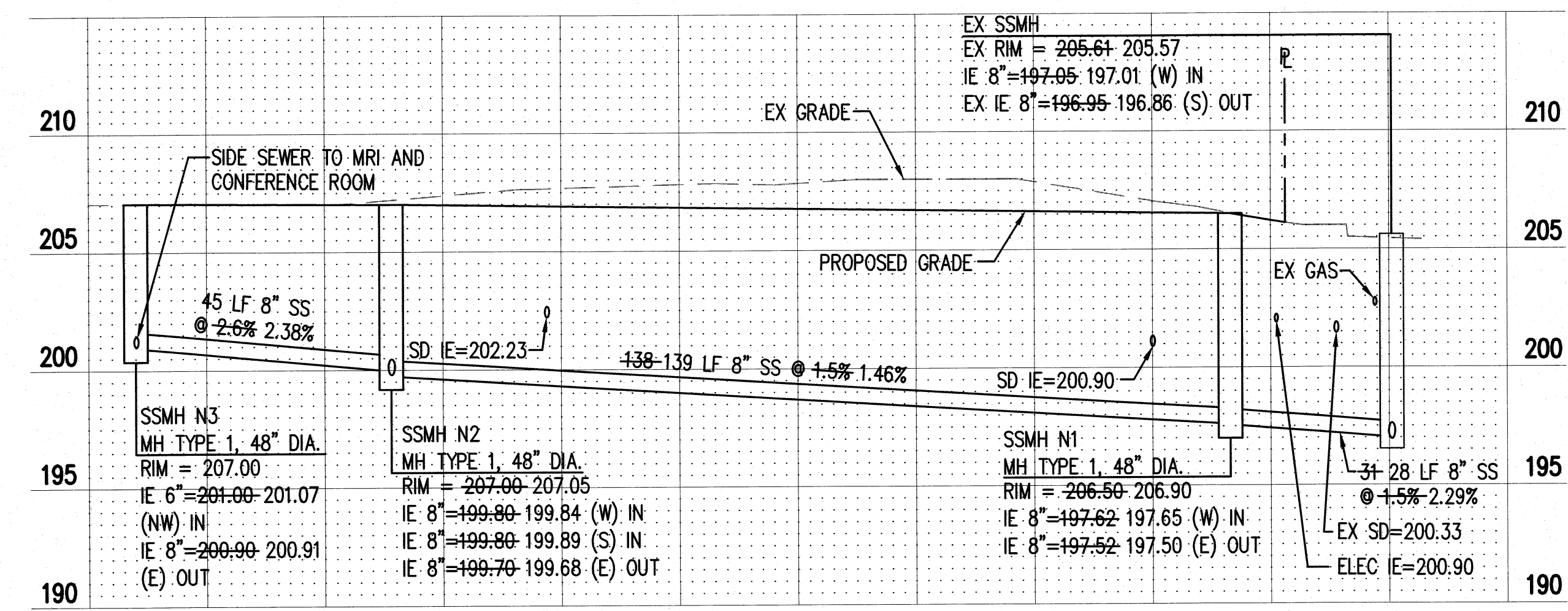
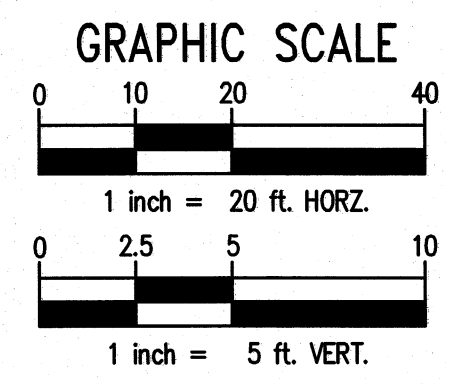

SANITARY SEWER PROFILE
FACING NORTH - SCALE: AS NOTED

NOTE: CONTRACTOR SHALL VERIFY INVERT AT LOCATION OF PROPOSED SSMH S1 AND NOTIFY ENGINEER OF VALUE. SLOPE TO BE ADJUSTED TO OBTAIN CONSTANT SLOPE BETWEEN MANHOLE AND CLEANOUT.

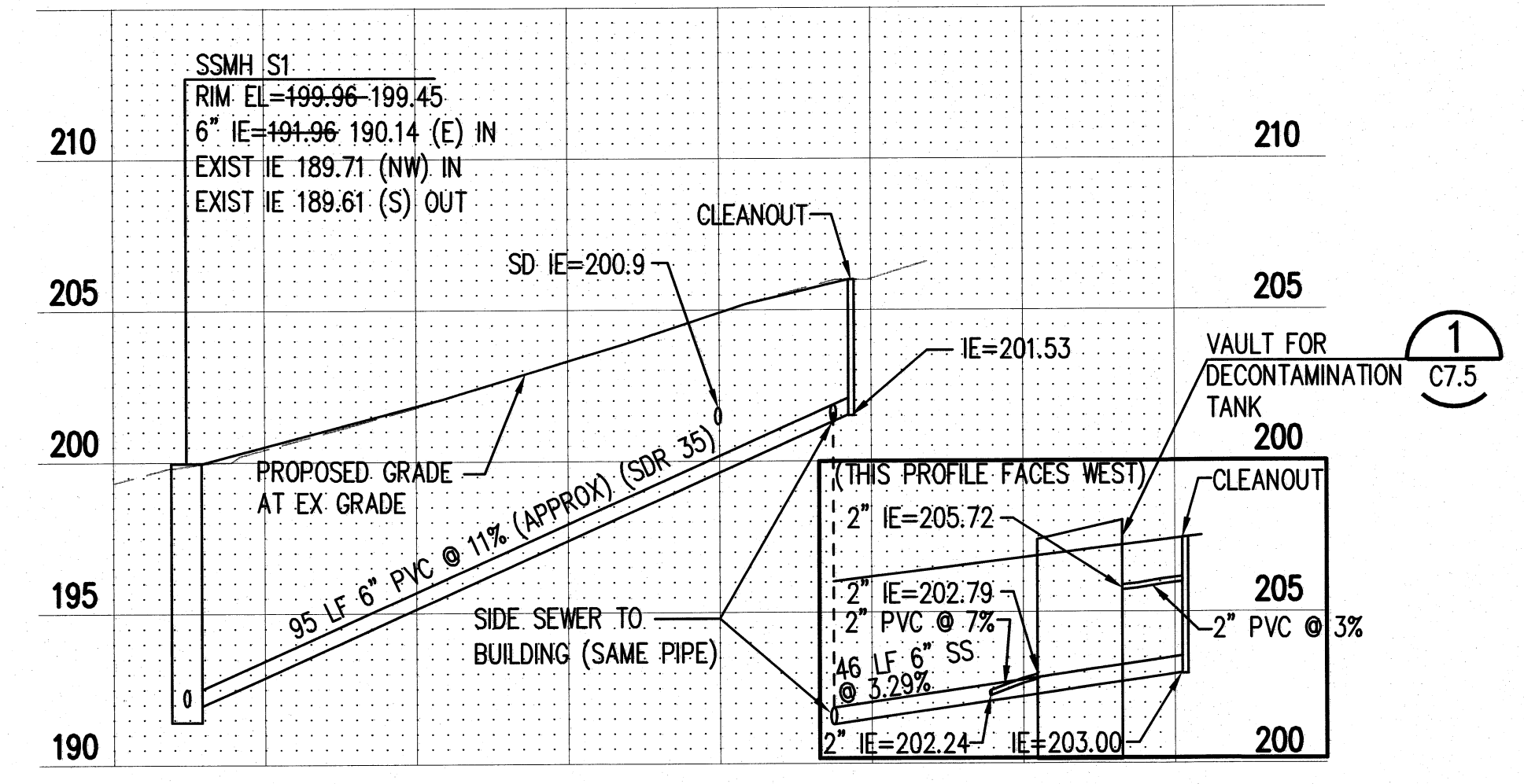

SANITARY SEWER PROFILE
FACING NORTH - SCALE: AS NOTED

RECORD DRAWINGS
THESE RECORD DOCUMENTS HAVE BEEN PREPARED FROM THE CONTRACTOR'S TOPOGRAPHIC SURVEY AND RED-LINED MARK-UPS OF THE CONSTRUCTION DOCUMENTS. THE ENGINEER OF RECORD SIGNING THESE RECORD DRAWINGS HAS NOT WITNESSED ALL ELEMENTS OF CONSTRUCTION AND IS NOT RESPONSIBLE FOR ERRORS OR OMISSIONS IN DATA PROVIDED BY THE CONTRACTOR'S REDLINES.

AS-BUILT DRAWING APPROVAL
THIS PLAN SHEET HAS BEEN REVIEWED AND APPROVED FOR THE CONDITIONS ON THE TITLE SHEET.
BY: *Eve Scott*
City Engineer, CITY OF ARLINGTON
DATE: 6/12/2022

5	12/8/11	JRB	JRB	N/A	AS-BUILT RECORD DRAWINGS
4	10/27/08	KPK	KPK	MAV	RFI 56 - VAULT FOR DECONTAMINATION TANK
NO. DATE BY CHD. APPR. REVISION					

DRAWN BY PE/TAL
DESIGNED BY JRB/KPK
CHECKED BY JRB
APPROVED BY MAV
DATE 8/13/2008
JOB No. : 107369

CALL TWO BUSINESS DAYS BEFORE YOU DIG 1-800-424-5555
SCALE: AS NOTED

kpff Consulting Engineers
1601 Fifth Avenue, Suite 1600
Seattle, Washington 98101-3665
(206) 622-5822 Fax (206) 622-8130

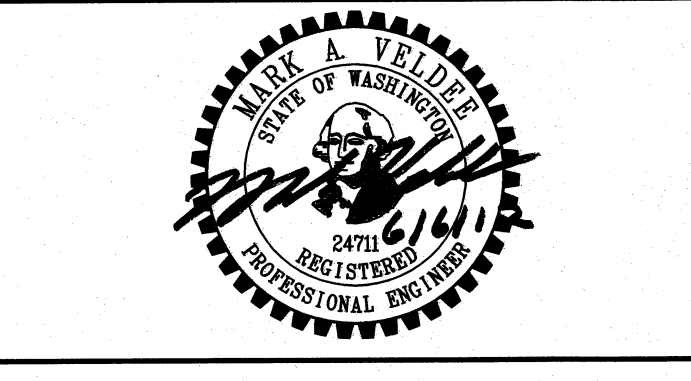

CASCADE VALLEY HOSPITAL & CLINICS
330 S. STILLAGUAMISH AVE., ARLINGTON, WA
**ON-SITE IMPROVEMENTS
SANITARY SEWER PROFILE**

SHEET
C5.1

X:\107369-107369\107369 (Cascade Valley Hosp)\CADD\Design\As-Built\CH-C5.1-SS PRD.dwg jrdamb Jun 06, 2012 - 8:53am

X:\107251-107500\107389 (Cascade Valley Hosp) CAD\Design\As-Built\CH-C6-06.1-3 OFFSITE WTR.dwg

Jun 06, 2012 - 8:55am jordanb

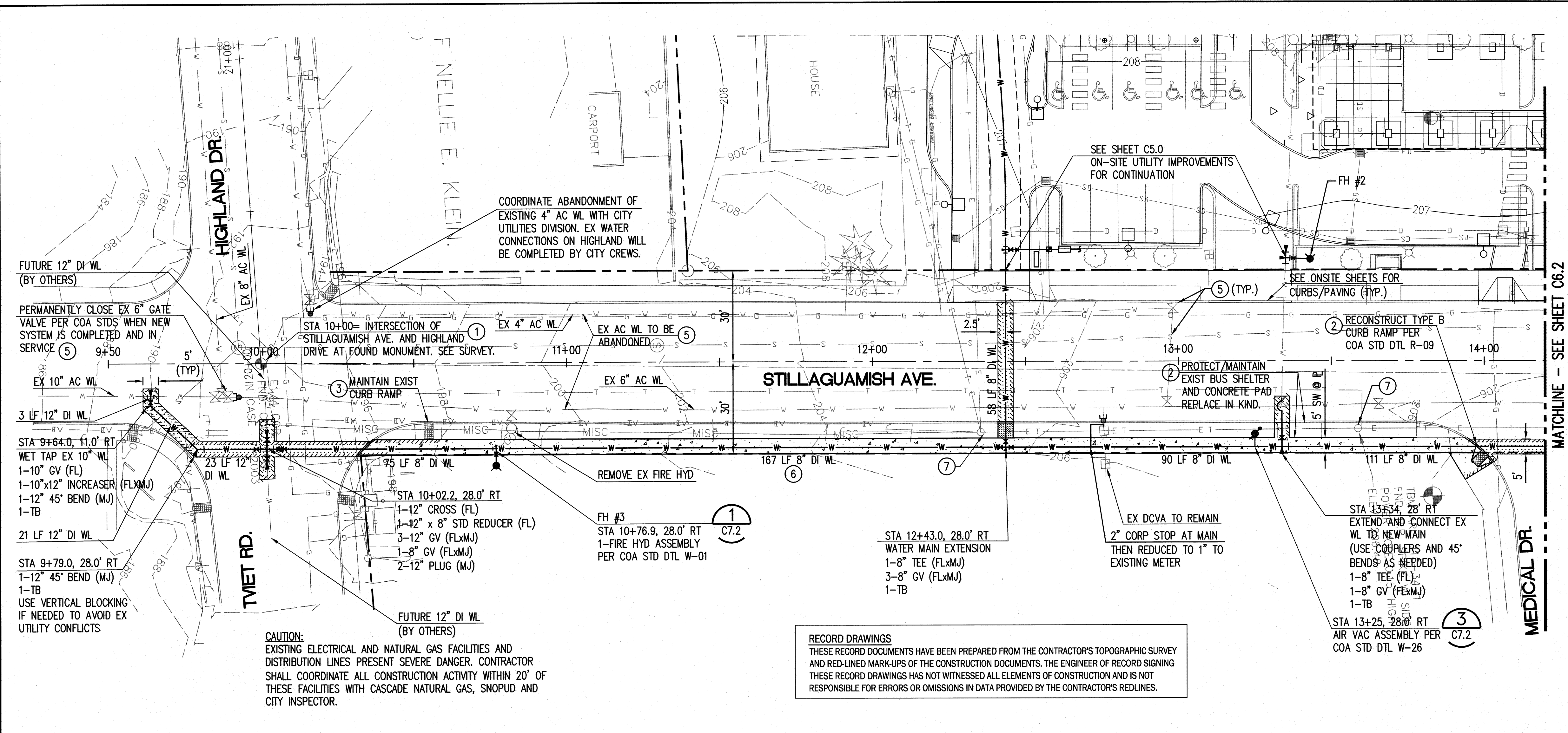

LEGEND:

- ASPHALT
- CONCRETE
- VEGETATION
- SAWCUT LINE
- PLUG PER COA STD (SEE NOTE 5)

GRAPHIC SCALE

1 inch = 20 ft. HOR.
1 inch = 5 ft. VERT.

- GENERAL NOTES:**
- PROPOSED WATER MAIN AND SERVICE CONNECTIONS WILL BE CONSTRUCTED WITHIN CORRIDORS THAT CONTAIN MANY EXISTING BELOW-GRADE UTILITIES. PRIOR TO CONSTRUCTION THE CONTRACTOR SHALL HAVE ALL EXISTING UTILITIES FIELD LOCATED AND SHALL POTHOLE UTILITIES AT PROPOSED POINTS OF CROSSING. INFORM OWNERS REPRESENTATIVE IF FOUND LOCATIONS CONFLICT WITH PROPOSED HORIZONTAL OR VERTICAL ALIGNMENTS OF WATER MAINS AND SERVICES.
 - ELEVATIONS OF INTERSECTING UTILITIES SHOWN IN THE PROFILE HAVE BEEN ESTIMATED BASED ON STANDARD DEPTHS OF COVER.
 - CONTRACTOR SHALL LIMIT CONSTRUCTION OPERATIONS TO WITHIN PUBLIC ROW EXCEPT AS NECESSARY. IF ADJACENT PROPERTY IS TO BE IMPACTED DURING CONSTRUCTION, CONTRACTOR SHALL SEEK APPROVAL OF PROPERTY OWNER THROUGH CITY INSPECTOR AND OWNER'S REPRESENTATIVE BEFOREHAND.
 - CONTRACTOR SHALL COORDINATE CONSTRUCTION ACTIVITIES SUCH THAT (A) HOSPITAL UTILITY SERVICES ARE MAINTAINED DURING CONSTRUCTION, (OR AS OTHERWISE COORDINATED WITH OWNER'S REPRESENTATIVE) AND (B) CITY SERVICES ARE MAINTAINED AND TEMPORARY INTERRUPTIONS ARE COORDINATED WITH THE CITY OF ARLINGTON PUBLIC WORKS AND FIRE DEPARTMENT.
 - ALL BENDS SHALL UTILIZE MEGA-LUG FITTINGS

- CONSTRUCTION NOTES:**
- HORIZONTAL CONTROL OF ROADWAY BASELINE STATIONING AND PROPOSED WATER MAIN IS BASED UPON STILLAGUAMISH AVENUE CENTERLINE. SEE SURVEY FOR CONTROL OF CENTERLINE. STATION 10+00 IS AT THE INTERSECTION OF HIGHLAND/TVIET AND STILLAGUAMISH AVE.
 - ANY PAVEMENT, SIDEWALK OR LANDSCAPING DISTURBED DURING CONSTRUCTION SHALL BE REPLACED IN KIND PER COA STANDARDS.
 - DURING CONSTRUCTION, CONTRACTOR SHALL PROTECT EXISTING SURFACE FEATURES AND UTILITIES FROM DAMAGE AND DESTABILIZATION.
 - PRIOR TO CONSTRUCTION, CONTRACTOR SHALL POTHOLE EXISTING UTILITIES WHERE PROPOSED WATER LINE WILL INTERSECT OR CONNECT TO CONFIRM CONSTRUCTABLE. COORDINATE WORK WITH AFFECTED UTILITY OWNER.
 - EXISTING AC WATERMAIN SHALL BE ABANDONED AFTER NEW WATERMAIN IS INSTALLED AND SERVICES ARE OPERATIONAL PER COA REQUIREMENTS. PLUG ENDS OF ABANDONED MAIN WITH CLASS 2500 CONCRETE AT VALVES. CONTRACTOR SHALL REMOVE VALVE EXTENSION AND CASING DOWN TO 18" BELOW GRADE, FILL VOID WITH CDF, AND PATCH ASPHALT WITH 4" THICK CLASS B.
 - PIPE LENGTHS SHOWN ARE BETWEEN FITTINGS.
 - CONTRACTOR SHALL COORDINATE WATERLINE INSTALLATION NEAR POWER POLES WITH SNOPOD PRIOR TO CONSTRUCTION.

RECORD DRAWINGS
THESE RECORD DOCUMENTS HAVE BEEN PREPARED FROM THE CONTRACTOR'S TOPOGRAPHIC SURVEY AND RED-LINED MARK-UPS OF THE CONSTRUCTION DOCUMENTS. THE ENGINEER OF RECORD SIGNING THESE RECORD DRAWINGS HAS NOT WITNESSED ALL ELEMENTS OF CONSTRUCTION AND IS NOT RESPONSIBLE FOR ERRORS OR OMISSIONS IN DATA PROVIDED BY THE CONTRACTOR'S REDLINES.

CAUTION:
EXISTING ELECTRICAL AND NATURAL GAS FACILITIES AND DISTRIBUTION LINES PRESENT SEVERE DANGER. CONTRACTOR SHALL COORDINATE ALL CONSTRUCTION ACTIVITY WITHIN 20' OF THESE FACILITIES WITH CASCADE NATURAL GAS, SNOPOD AND CITY INSPECTOR.

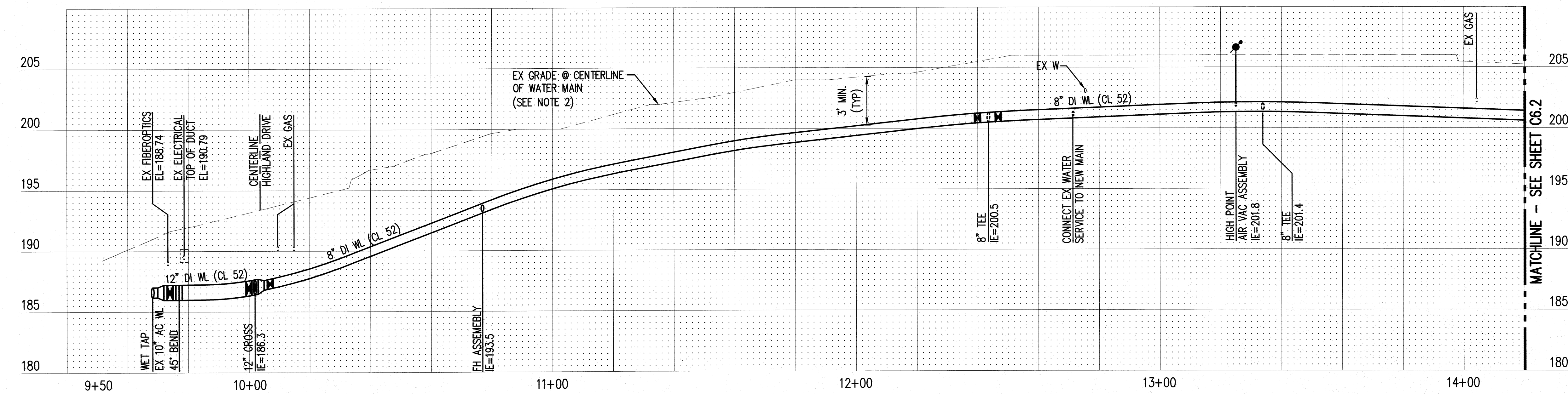

AS-BUILT DRAWING APPROVAL

THIS PLAN SHEET HAS BEEN REVIEWED AND APPROVED PER THE CONDITIONS ON THE TITLE SHEET.

BY: *Eric Best*
City Engineer, CITY OF ARLINGTON

DATE: 6/12/2012

NO.	DATE	BY	CHD.	APPR.	REVISION
1	12/8/11	JRB	JRB	N/A	AS-BUILT RECORD DRAWINGS

DRAWN BY: PE/TAL
DESIGNED BY: JRB/KPK
CHECKED BY: JRB
APPROVED BY: MAV

DATE: 8/13/2008

J O B No. : 107369

CALL TWO BUSINESS DAYS BEFORE YOU DIG
1-800-424-5555

SCALE: AS NOTED

kpfi Consulting Engineers
1601 Fifth Avenue, Suite 1600
Seattle, Washington 98101-3665
(206) 622-5822 Fax (206) 622-8130

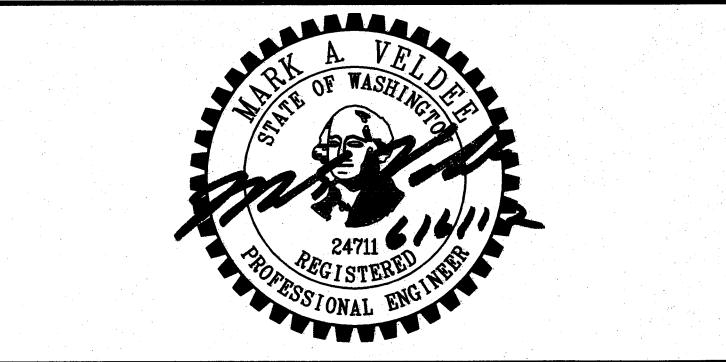

CASCADE VALLEY HOSPITAL & CLINICS
330 S. STILLAGUAMISH AVE., ARLINGTON, WA

**OFF-SITE IMPROVEMENTS
WATER MAIN REPLACEMENT PLAN & PROFILE**

SHEET

C6.1

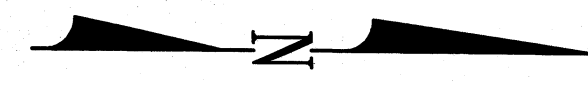

GRAPHIC SCALE

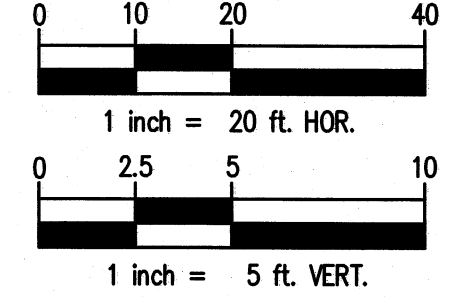

LEGEND:

- ASPHALT
- CONCRETE
- VEGETATION
- SAWCUT LINE

PLUG PER COA STD (SEE NOTE 5)

GENERAL NOTES:

1. PROPOSED WATER MAIN AND SERVICE CONNECTIONS WILL BE CONSTRUCTED WITHIN CORRIDORS THAT CONTAIN MANY EXISTING BELOW GRADE UTILITIES. PRIOR TO CONSTRUCTION THE CONTRACTOR SHALL HAVE ALL EXISTING UTILITIES FIELD LOCATED AND SHALL POTHOLE UTILITIES AT PROPOSED POINTS OF CROSSING. INFORM OWNERS REPRESENTATIVE IF FOUND LOCATIONS CONFLICT WITH PROPOSED HORIZONTAL OR VERTICAL ALIGNMENTS OF WATER MAINS AND SERVICES.
2. ELEVATIONS OF INTERSECTING UTILITIES SHOWN IN THE PROFILE HAVE BEEN ESTIMATED BASED ON STANDARD DEPTHS OF COVER.
3. CONTRACTOR SHALL LIMIT CONSTRUCTION OPERATIONS TO WITHIN PUBLIC ROW EXCEPT AS NECESSARY. IF ADJACENT PROPERTY IS TO BE IMPACTED DURING CONSTRUCTION, CONTRACTOR SHALL SEEK APPROVAL OF PROPERTY OWNER THROUGH CITY INSPECTOR AND OWNER'S REPRESENTATIVE BEFOREHAND.
4. CONTRACTOR SHALL COORDINATE CONSTRUCTION ACTIVITIES SUCH THAT (A) HOSPITAL UTILITY SERVICES ARE MAINTAINED DURING CONSTRUCTION, (OR AS OTHERWISE COORDINATED WITH OWNER'S REPRESENTATIVE) AND (B) CITY SERVICES ARE MAINTAINED AND TEMPORARY INTERRUPTIONS ARE COORDINATED WITH THE CITY OF ARLINGTON PUBLIC WORKS AND FIRE DEPARTMENT.
5. ALL BENDS SHALL UTILIZE MEGA-LUG FITTINGS

CONSTRUCTION NOTES:

- ① HORIZONTAL CONTROL OF ROADWAY BASELINE STATIONING AND PROPOSED WATER MAIN IS BASED UPON STILLAGUAMISH AVENUE CENTERLINE. SEE SURVEY FOR CONTROL OF CENTERLINE. STATION 10+00 IS AT THE INTERSECTION OF HIGHLAND/TVIET AND STILLAGUAMISH AVE.
- ② ANY PAVEMENT, SIDEWALK OR LANDSCAPING DISTURBED DURING CONSTRUCTION SHALL BE REPLACED IN KIND PER COA STANDARDS.
- ③ DURING CONSTRUCTION, CONTRACTOR SHALL PROTECT EXISTING SURFACE FEATURES AND UTILITIES FROM DAMAGE AND DESTABILIZATION.
- ④ PRIOR TO CONSTRUCTION, CONTRACTOR SHALL POTHOLE EXISTING UTILITIES WHERE PROPOSED WATER LINE WILL INTERSECT OR CONNECT TO CONFIRM CONSTRUCTABLE. COORDINATE WORK WITH AFFECTED UTILITY OWNER.
- ⑤ EXISTING AC WATERMAIN SHALL BE ABANDONED AFTER NEW WATERMAIN IS INSTALLED AND SERVICES ARE OPERATIONAL PER COA REQUIREMENTS. PLUG ENDS OF ABANDONED MAIN WITH CLASS 2500 CONCRETE AT VALVES. CONTRACTOR SHALL REMOVE VALVE EXTENSION AND CASING DOWN TO 18" BELOW GRADE, FILL VOID WITH CDF, AND PATCH ASPHALT WITH 4" THICK CLASS B.
- ⑥ PIPE LENGTHS SHOWN ARE BETWEEN FITTINGS.
- ⑦ CONTRACTOR SHALL COORDINATE WATERLINE INSTALLATION NEAR POWER POLES WITH SNOPOD PRIOR TO CONSTRUCTION.

AS-BUILT DRAWING APPROVAL

THIS PLAN SHEET HAS BEEN REVIEWED AND APPROVED PER THE CONDITIONS ON THE TITLE SHEET.

BY: *Eve Best*
City Engineer, CITY OF ARLINGTON

DATE: 6/12/2012

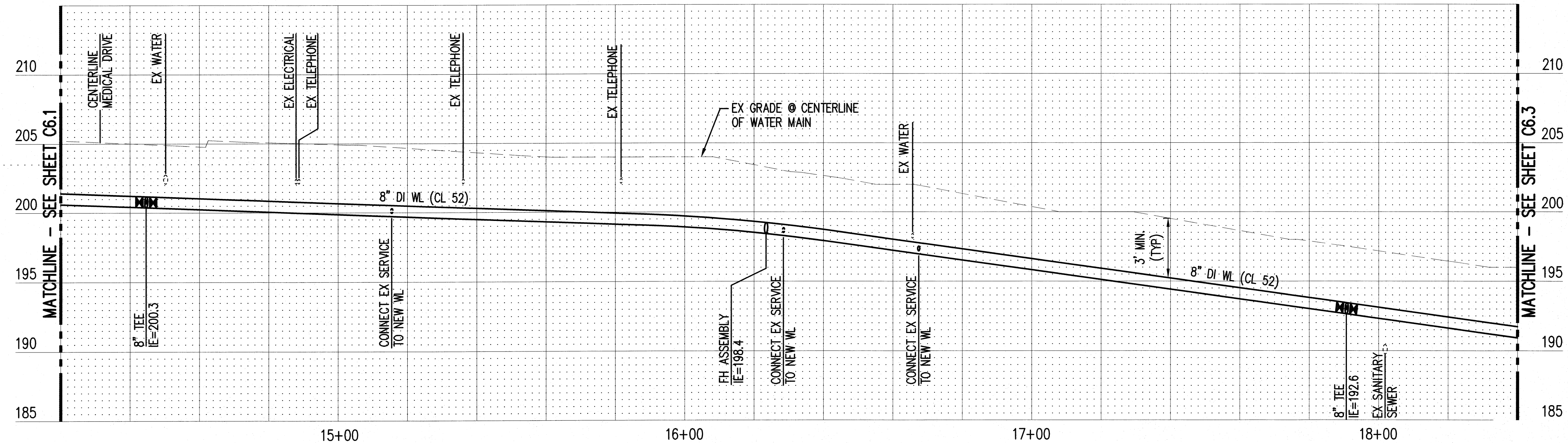
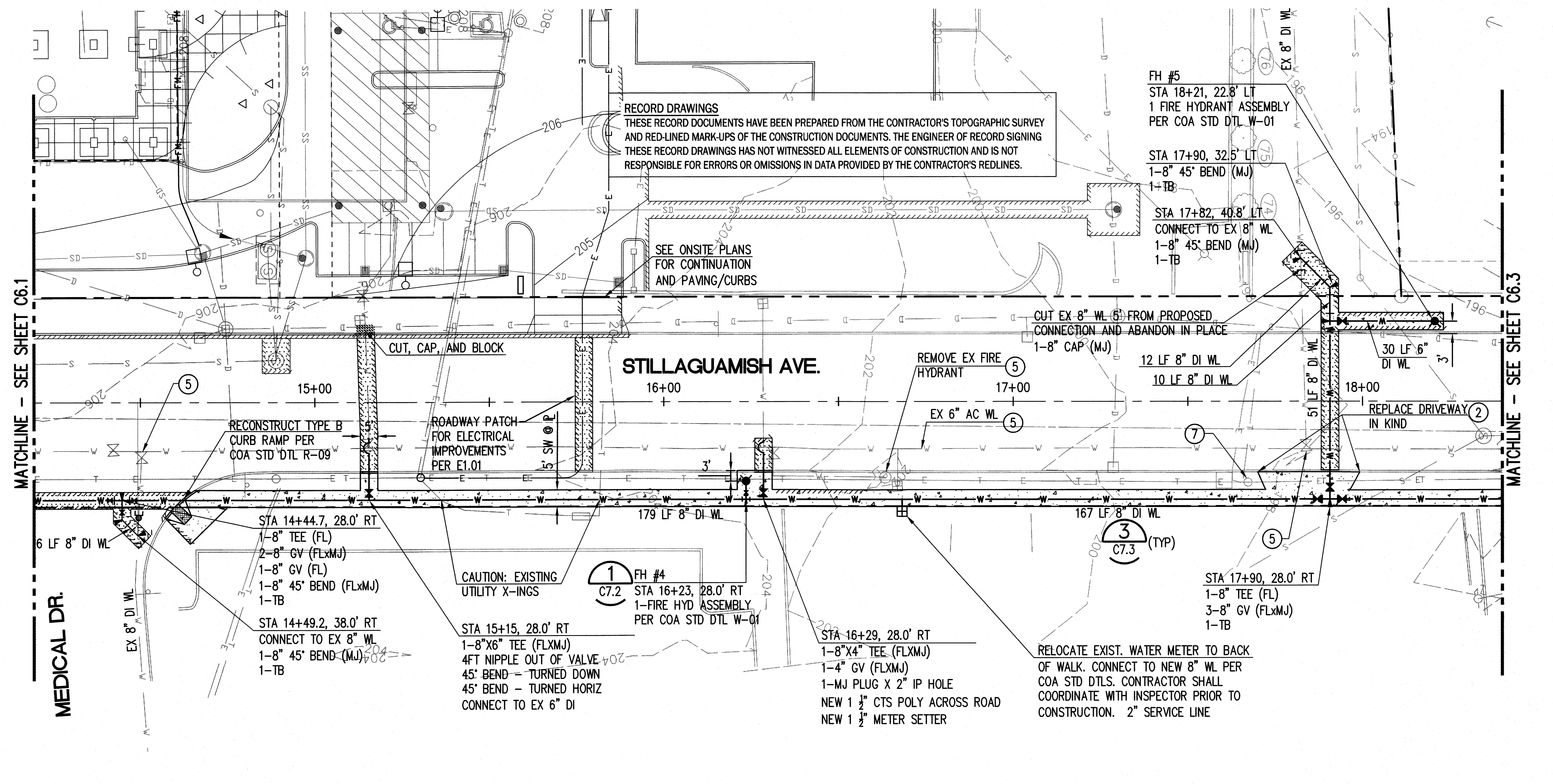

RECORD DRAWINGS
THESE RECORD DOCUMENTS HAVE BEEN PREPARED FROM THE CONTRACTOR'S TOPOGRAPHIC SURVEY AND RED-LINED MARK-UPS OF THE CONSTRUCTION DOCUMENTS. THE ENGINEER OF RECORD SIGNING THESE RECORD DRAWINGS HAS NOT WITNESSED ALL ELEMENTS OF CONSTRUCTION AND IS NOT RESPONSIBLE FOR ERRORS OR OMISSIONS IN DATA PROVIDED BY THE CONTRACTOR'S REDLINES.

SEE ONSITE PLANS FOR CONTINUATION AND PAVING/CURBS

STILLAGUAMISH AVE.

CAUTION: EXISTING UTILITY X-INGS

RELOCATE EXIST. WATER METER TO BACK OF WALK. CONNECT TO NEW 8" WL PER COA STD D.T.L.S. CONTRACTOR SHALL COORDINATE WITH INSPECTOR PRIOR TO CONSTRUCTION. 2" SERVICE LINE

X:\107251-107500\107369 (Cascade Valley Hosp)\CAD\Design\As-Built\CAD-CO-C6.1-3 OFFSITE WTR.dwg
 jordanb
 Jun 06, 2012 - 8:56am

NO.	DATE	BY	CHD.	APPR.	REVISION
2	3/30/12	JRB	JRB	N/A	AS-BUILT RECORD DRAWINGS
1	12/8/11	JRB	JRB	N/A	AS-BUILT RECORD DRAWINGS

DRAWN BY PE/TAL
DESIGNED BY JRB/KPK
CHECKED BY JRB
APPROVED BY MAV
DATE 8/13/2008
JOB No.: 107369

CALL TWO BUSINESS DAYS BEFORE YOU DIG 1-800-424-5555

kpf1 Consulting Engineers
1601 Fifth Avenue, Suite 1600
Seattle, Washington 98101-3665
(206) 622-5822 Fax (206) 622-8130

SCALE: AS NOTED

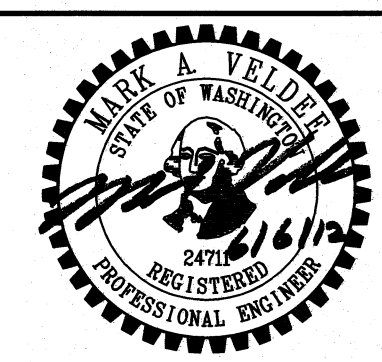

CASCADE VALLEY HOSPITAL & CLINICS
330 S. STILLAGUAMISH AVE., ARLINGTON, WA

OFF-SITE IMPROVEMENTS
WATER MAIN REPLACEMENT PLAN & PROFILE

SHEET C6.2

X:\107251-107500\107500 (Cascade Valley Hosp) \CADD (Design As-Built) \CH-C6.1-3 OFFSITE WTR.dwg
 jordanb
 Jun 06, 2012 - 8:57am

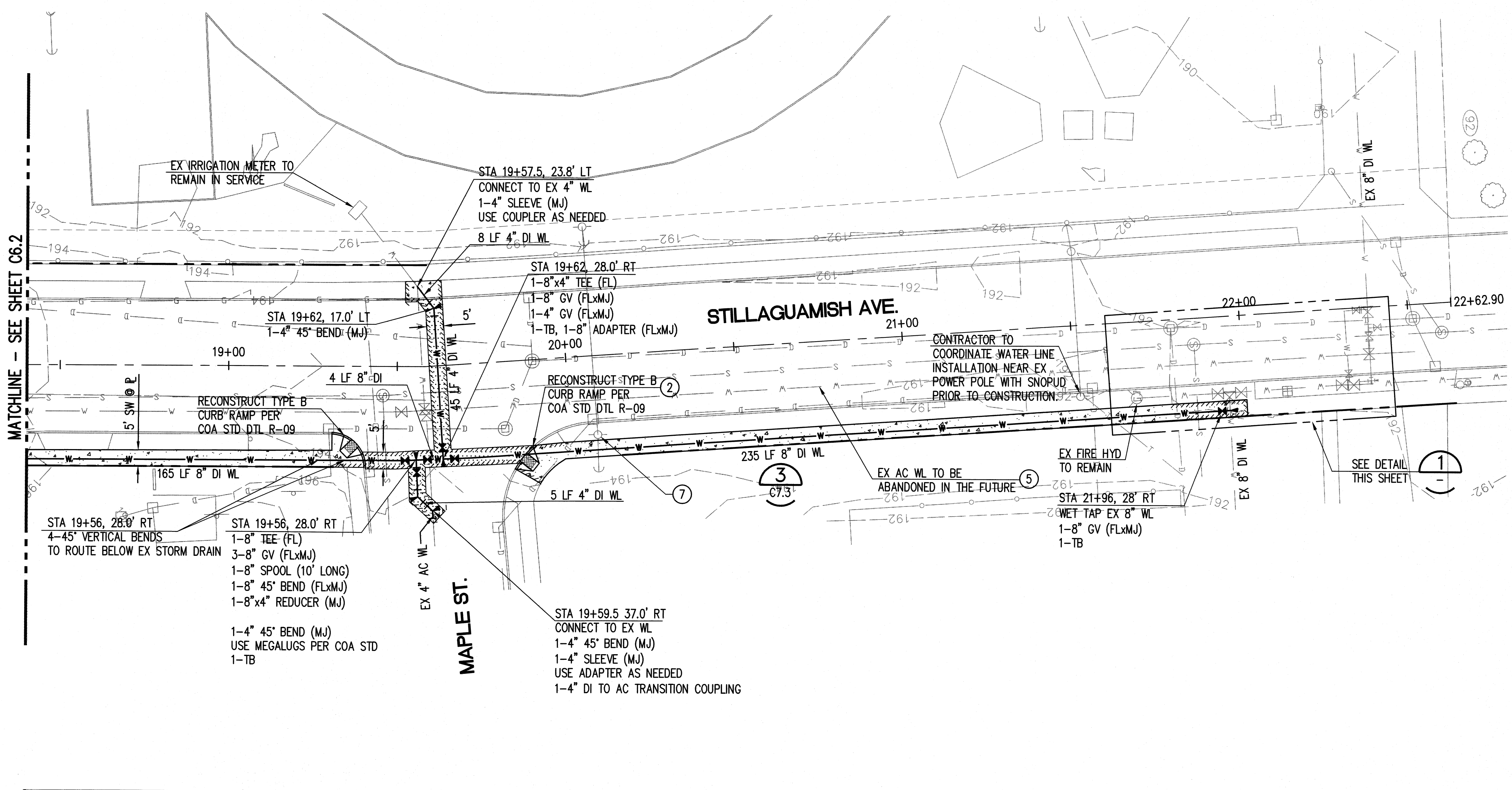

LEGEND:

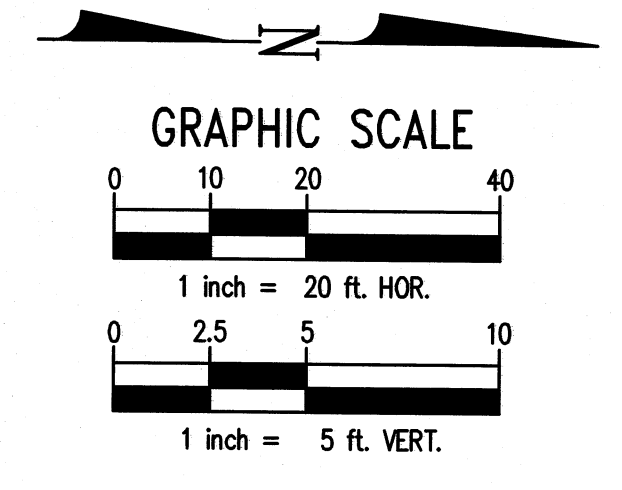
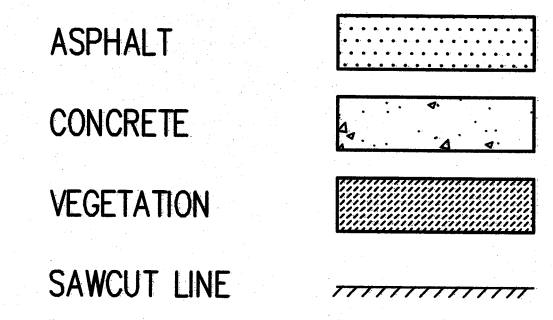

GENERAL NOTES:

1. PROPOSED WATER MAIN AND SERVICE CONNECTIONS WILL BE CONSTRUCTED WITHIN CORRIDORS THAT CONTAIN MANY EXISTING BELOW GRADE UTILITIES. PRIOR TO CONSTRUCTION THE CONTRACTOR SHALL HAVE ALL EXISTING UTILITIES FIELD LOCATED AND SHALL POTHOLE UTILITIES AT PROPOSED POINTS OF CROSSING. INFORM OWNERS REPRESENTATIVE IF FOUND LOCATIONS CONFLICT WITH PROPOSED HORIZONTAL OR VERTICAL ALIGNMENTS OF WATER MAINS AND SERVICES.
2. ELEVATIONS OF INTERSECTING UTILITIES SHOWN IN THE PROFILE HAVE BEEN ESTIMATED BASED ON STANDARD DEPTHS OF COVER.
3. CONTRACTOR SHALL LIMIT CONSTRUCTION OPERATIONS TO WITHIN PUBLIC ROW EXCEPT AS NECESSARY. IF ADJACENT PROPERTY IS TO BE IMPACTED DURING CONSTRUCTION, CONTRACTOR SHALL SEEK APPROVAL OF PROPERTY OWNER THROUGH CITY INSPECTOR AND OWNER'S REPRESENTATIVE BEFOREHAND.
4. CONTRACTOR SHALL COORDINATE CONSTRUCTION ACTIVITIES SUCH THAT (A) HOSPITAL UTILITY SERVICES ARE MAINTAINED DURING CONSTRUCTION, (OR AS OTHERWISE COORDINATED WITH OWNER'S REPRESENTATIVE) AND (B) CITY SERVICES ARE MAINTAINED AND TEMPORARY INTERRUPTIONS ARE COORDINATED WITH THE CITY OF ARLINGTON PUBLIC WORKS AND FIRE DEPARTMENT.
5. ALL BENDS SHALL UTILIZE MEGA-LUG FITTINGS

CONSTRUCTION NOTES:

- ① HORIZONTAL CONTROL OF ROADWAY BASELINE STATIONING AND PROPOSED WATER MAIN IS BASED UPON STILLAGUAMISH AVENUE CENTERLINE. SEE SURVEY FOR CONTROL OF CENTERLINE. STATION 10+00 IS AT THE INTERSECTION OF HIGHLAND/TWENT AND STILLAGUAMISH AVE.
- ② ANY PAVEMENT, SIDEWALK OR LANDSCAPING DISTURBED DURING CONSTRUCTION SHALL BE REPLACED IN KIND PER COA STANDARDS.
- ③ DURING CONSTRUCTION, CONTRACTOR SHALL PROTECT EXISTING SURFACE FEATURES AND UTILITIES FROM DAMAGE AND DESTABILIZATION.
- ④ PRIOR TO CONSTRUCTION, CONTRACTOR SHALL POTHOLE EXISTING UTILITIES WHERE PROPOSED WATER LINE WILL INTERSECT OR CONNECT TO CONFIRM CONSTRUCTABLE. COORDINATE WORK WITH AFFECTED UTILITY OWNER.
- ⑤ EXISTING AC WATERMAIN SHALL BE ABANDONED AFTER NEW WATERMAIN IS INSTALLED AND SERVICES ARE OPERATIONAL PER COA REQUIREMENTS. PLUG ENDS OF ABANDONED MAIN WITH CLASS 2500 CONCRETE AT VALVES. CONTRACTOR SHALL REMOVE VALVE EXTENSION AND CASING DOWN TO 18" BELOW GRADE, FILL VOID WITH CDF, AND PATCH ASPHALT WITH 4" THICK CLASS B.
- ⑥ PIPE LENGTHS SHOWN ARE BETWEEN FITTINGS.
- ⑦ CONTRACTOR SHALL COORDINATE WATERLINE INSTALLATION NEAR POWER POLES WITH SNOPOD PRIOR TO CONSTRUCTION.

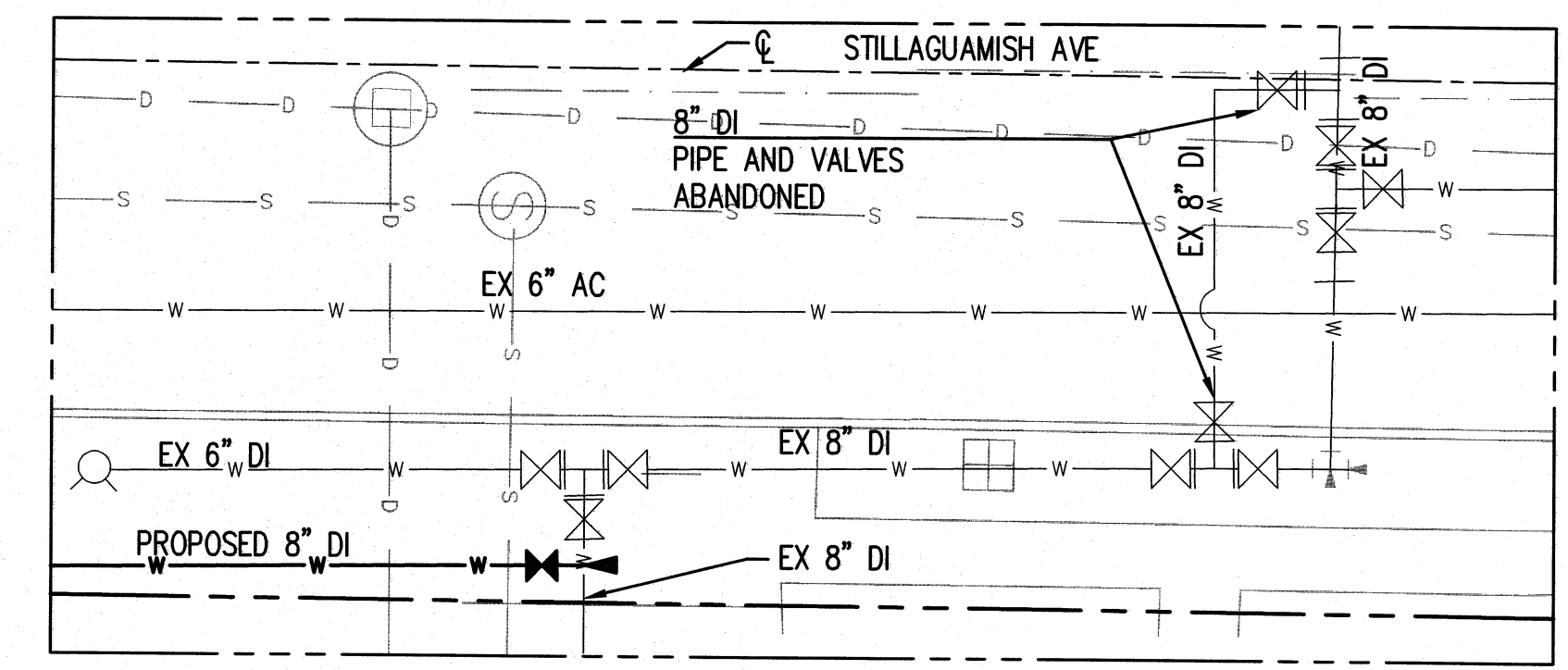
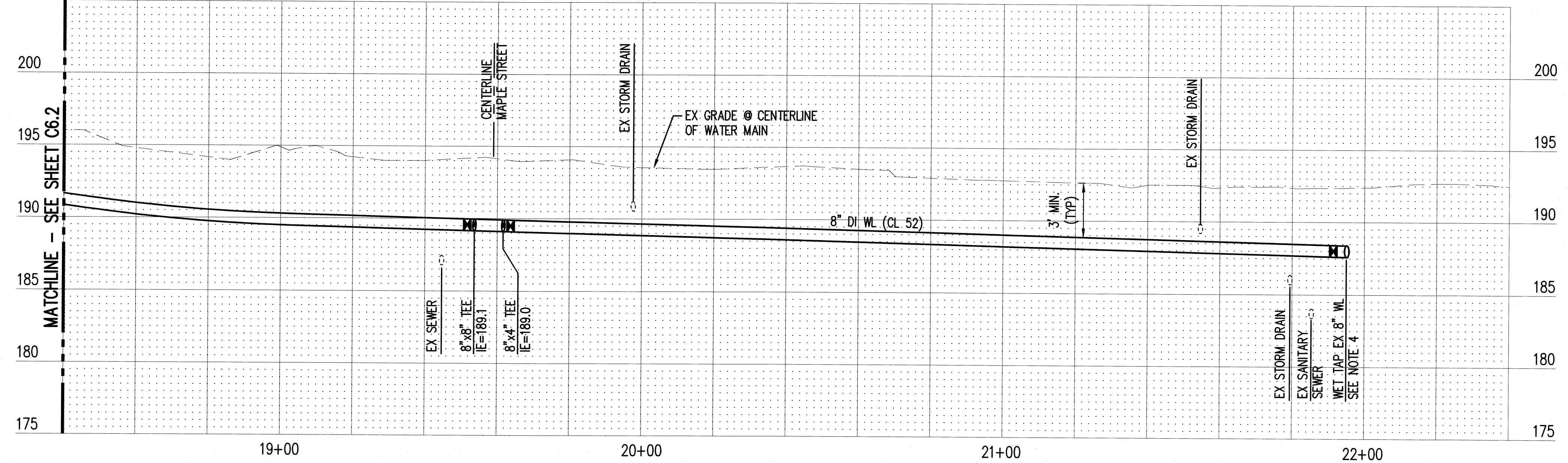

RECORD DRAWINGS
 THESE RECORD DOCUMENTS HAVE BEEN PREPARED FROM THE CONTRACTOR'S TOPOGRAPHIC SURVEY AND RED-LINED MARK-UPS OF THE CONSTRUCTION DOCUMENTS. THE ENGINEER OF RECORD SIGNING THESE RECORD DRAWINGS HAS NOT WITNESSED ALL ELEMENTS OF CONSTRUCTION AND IS NOT RESPONSIBLE FOR ERRORS OR OMISSIONS IN DATA PROVIDED BY THE CONTRACTOR'S REDLINES.

AS-BUILT DRAWING APPROVAL
 THIS PLAN SHEET HAS BEEN REVIEWED AND APPROVED PER THE CONDITIONS ON THE TITLE SHEET.
 BY: *Eric Scott*
 City Engineer, CITY OF ARLINGTON
 DATE: 6/12/2012

NO.	DATE	BY	CHD.	APPR.	REVISION
2	3/29/12	JRB	JRB	N/A	AS-BUILT RECORD DRAWINGS
1	12/8/11	JRB	JRB	N/A	AS-BUILT RECORD DRAWINGS

DRAWN BY PE/TAL
 DESIGNED BY JRB/KPK
 CHECKED BY JRB
 APPROVED BY MAV
 DATE 8/13/2008
 JOB No.: 107369

CALL TWO BUSINESS DAYS BEFORE YOU DIG
1-800-424-5555
kpff Consulting Engineers
 1601 Fifth Avenue, Suite 1600
 Seattle, Washington 98101-3665
 (206) 622-5822 Fax (206) 622-8130



CASCADE VALLEY HOSPITAL & CLINICS
 330 S. STILLAGUAMISH AVE., ARLINGTON, WA
OFF-SITE IMPROVEMENTS
WATER MAIN REPLACEMENT PLAN & PROFILE

SHEET
C6.3