

**TOP VIEW**

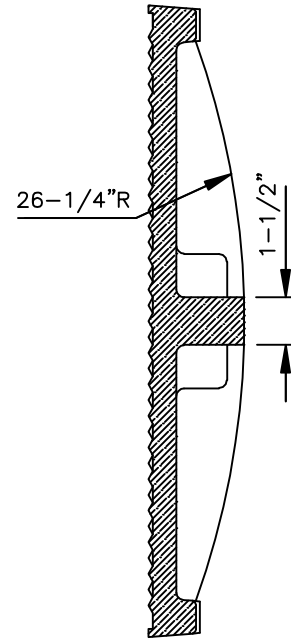

**SECTION B-B**

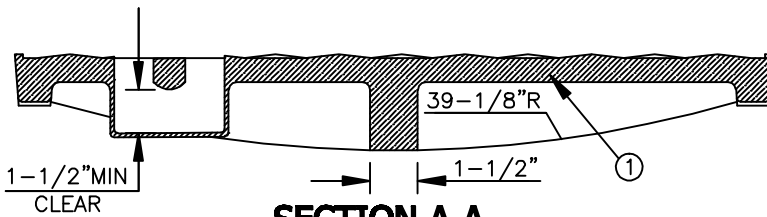

**SECTION A-A**

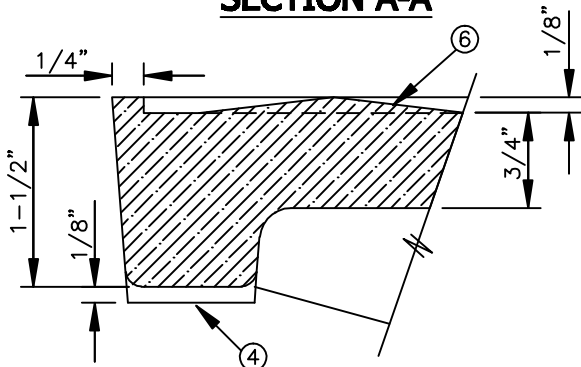

**SECTION C-C**

**NOTE:**

- ① MATERIAL USED SHALL BE DUCTILE IRON PER ASTM-A536, GRADE 80-55-06, WITH BITUMINOUS COATING.
- ② LOCKING HOLES TO BE PROVIDED IN CASTING TO ALLOW FOR TWO 5/8" DIA STAINLESS STEEL, SOCKET HEAD CAP SCREWS. NO PART OF SCREW WILL PROTRUDE ABOVE GRATE.
- ③ GRATE TO BE USED WITH FRAME SHOWN IN STD DETAIL SD-090.
- ④ GRATE SEATING: 8 INTEGRALLY CAST PADS.
- ⑤ CAST POCKET LIFT HANDLE.
- ⑥ NON-SKID DIAMOND PATTERN APPROX 2-1/2"x1"x1/8" HIGH



APPROVED BY	L. OLIVE
DATE	07/31/2008
REF STAN SPEC	

DEPARTMENT OF PUBLIC WORKS  
STANDARD DETAIL

SOLID COVER

STANDARD DETAIL  
NUMBER

SD-080