

STA 6+87.77 MATCH LINE TO SHEET 2

GENERAL NOTES:

1. ALL WORK AND MATERIALS SHALL BE IN ACCORDANCE WITH THE CITY OF ARLINGTON AND WASHINGTON STATE DEPARTMENT OF TRANSPORTATION 2010 STANDARD SPECIFICATIONS FOR ROAD, BRIDGE, AND MUNICIPAL CONSTRUCTION AND THE 2010 WSDOT HYDRAULICS MANUAL.
2. THE CONTRACTOR SHALL BE RESPONSIBLE FOR VERIFYING LOCATION OF EXISTING UTILITIES PRIOR TO CONSTRUCTION. UTILITIES SHOWN HEREON ARE FOR THE PURPOSE OF ASSISTING THE CONTRACTOR IN LOCATING SAID FACILITIES. NO WARRANTY IS EXPRESSED OR IMPLIED AS TO THE ACCURACY OR COMPLETION SHOWN. THE CONTRACTOR SHALL CALL DIAL-DIG 48 HOURS PRIOR TO CONSTRUCTION (1-800-424-5555).
3. THE CONTRACTOR SHALL BE RESPONSIBLE FOR MAINTAINING AND/OR REPAIRING ASPHALT AND GRAVEL SURFACES DISTURBED AS A RESULT OF THIS CONSTRUCTION UNTIL THEY ARE ACCEPTED BY THE CITY.
4. THE CONTRACTOR SHALL BE RESPONSIBLE FOR OBTAINING ALL PERMITS FOR UTILITY CONSTRUCTION.
5. ALL FILLS SHALL BE COMPACTED TO A MINIMUM OF 95% OF MAXIMUM DENSITY BY MODIFIED PROCTOR TEST.
6. PROVIDE AND MAINTAIN THE TEMPORARY SEDIMENTATION COLLECTION FACILITIES TO ENSURE SEDIMENT LADEN WATERS DO NOT ENTER THE NATURAL DRAINAGE SYSTEM.
7. THE DEVELOPER/OWNER IS RESPONSIBLE FOR WATER QUALITY.
8. S.W.P.P.P. MEASURES SHALL BE INSTALLED PRIOR TO ANY OTHER SITE WORK. THESE S.W.P.P.P. MEASURES SHALL BE CONSIDERED MINIMUM TO BE INSTALLED UNLESS DIRECTED OTHERWISE.
9. SUFFICIENT S.W.P.P.P. BMP MATERIALS AND SUPPLIES TO PROTECT THE ENTIRE SITE SHALL BE STOCKPILED ON-SITE.
10. THE S.W.P.P.P. MEASURES TO BE REMOVED UPON THE COMPLETION OF SITE WORK AND/OR SITE STABILIZATION.

KEY SCHEDULE & NOTES:

- ▲ STA 1+00.76; 0.00' LT
PK NAIL IN ASPHALT
N 422791.47
E 1321325.60
- ▲ STA 2+09.10; 30.43' LT
EXISTING BACK OF CONCRETE CURB,
BEGIN TAPER FOR CENTENNIAL TRAIL
- ▲ CENTENNIAL TRAIL, WIDTH VARIES.
- ▲ STA 2+95.48; 0.00' LT
PK NAIL SET IN ASPHALT
N 422596.77
E 1321328.43
- ▲ STA 3+26.89; 10.77' LT
BEGIN PAINTED LANE STRIPE
REMOVE C/L LANE STRIPE TO SOUTH
END OF PROJECT
- ▲ STA 4+26.78; 0.00' LT
PK NAIL SET IN ASPHALT
N 422465.49
E 1321333.31
- ▲ STA 4+34.89; 15.80' LT
BEGIN 10 FT WIDE TRANSITION TO EXISTING
DRIVEWAY.
- ▲ STA 4+54.25; 14.55' LT
END OF TAPER OF CENTENNIAL TRAIL
BEGIN FULL WIDTH OF CENTENNIAL TRAIL
(SEE DETAILS 1 & 2, THIS SHEET).
- ▲ 10 FT WIDE TRANSITION FROM STANDARD TRAIL
SECTION TO EXISTING DRIVEWAY.
- ▲ STA 4+61.66; 2.04' LT
ANGLE POINT PAINTED LANE STRIPE
REMOVE LANE STRIPE TO SOUTH
END OF PROJECT
- ▲ STA 4+61.46; 9.97' RT
BEGIN PAINTED LANE STRIPE.
- ▲ STA 4+79.85; 13.83' LT
END 10 FT WIDE TRANSITION FROM DRIVEWAY
TO FULL WIDTH TRAIL SECTION
- ▲ STA 5+59.12; 0.00' LT
PK NAIL SET IN ASPHALT
N 422333.16
E 1321332.22
- ▲ FULL WIDTH TRAIL SECTION.
- ▲ REMOVE EXISTING LANE STRIPE
- ▲ REMOVE EXISTING C/L STRIPE
- ▲ INSTALL STOP BAR AS DIRECTED
BY THE CITY OF ARLINGTON
- ▲ INSTALL BOLLARDS AS DIRECTED
BY THE CITY OF ARLINGTON
- ▲ ASPHALT GRIND AREA
2" DEEP X 12' WIDE X 5' LONG

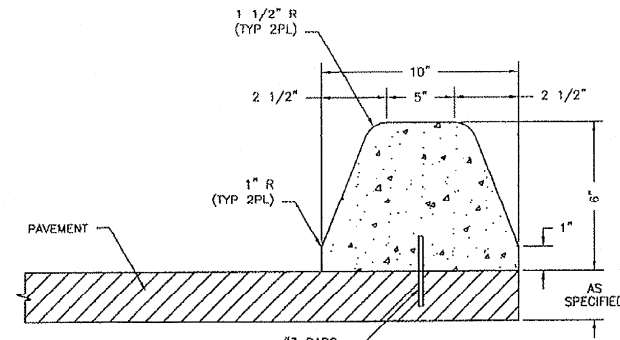

EXTRUDED CEMENT CONCRETE CURB

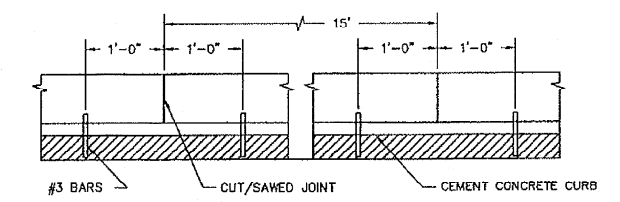

SPACING OF ANCHOR BARS

- LEGEND:**
- DENOTES SEWER MANHOLE
 - DENOTES CATCH BASIN
 - ◇ DENOTES POWER POLE
 - ⊠ DENOTES ELECTRIC BOX
 - ⊞ DENOTES TELEPHONE PEDESTAL
 - ⊞ DENOTES TRAFFIC SIGNAL JUNCTION BOX
 - ⊞ DENOTES LIGHT POLE
 - DENOTES MAILBOX
 - DENOTES 1.0' DIAMETER MAGNUM POWER CASE
 - X-X- DENOTES HOGWIRE FENCE
 - DENOTES CHAIN LINK FENCE
 - DENOTES WOOD FENCE
 - DHP- DENOTES POWER LINE
 - /// DENOTES EDGE OF ASPHALT
 - - - DENOTES CENTERLINE DITCH
 - ▲ DENOTES P.K. NAIL SET IN ASPHALT
 - ⊙ DENOTES NAIL SET IN ASPHALT

NOTES:

1. DUMMY JOINTS SHALL BE PLACED NOT TO EXCEED 15' ON CENTER. THRU JOINTS SHALL BE PLACED ONLY AT POINTS OF TANGENCY ON STREET ALLEY AND DRIVEWAY RETURNS AND WHERE THRU JOINTS OCCUR IN THE PAVEMENT SLAB.
2. CONCRETE SHALL BE CLASS 3000 OR COMMERCIAL WITH AIR-ENTRAINMENT.
3. AT THE CONTRACTOR'S OPTION CONCRETE CURBS MAY BE ANCHORED TO THE SIDE OF EVERY JOINT, OR BY USING AN ADHESIVE. THE ADHESIVE SHALL MEET THE REQUIREMENTS OF SECTION 9-20 OF THE WSDOT/APWA STANDARD SPECIFICATIONS FOR TYPE II EPOXY RESIN.

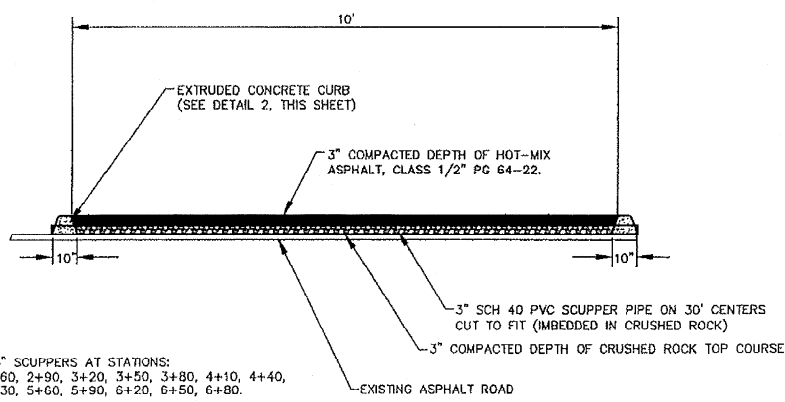

NOTE:
INSTALL 3" SCUPPERS AT STATIONS:
2+30, 2+60, 2+90, 3+20, 3+50, 3+80, 4+10, 4+40,
5+00, 5+30, 5+60, 5+90, 6+20, 6+50, 6+80.

**STA 4+79.85 TO STA 10+63.87
CENTENNIAL TRAIL SECTION**

1

2

**STANDARD DRAWING R-200
EXTRUDED CONCRETE CURB**

CALL TWO BUSINESS DAYS BEFORE YOU DIG
1-800-424-5555

CITY OF ARLINGTON

THIS SHEET HAS BEEN APPROVED PER THE CONDITIONS ON THE COVER SHEET.

BY: *Eric Smith*
CITY ENGINEER

DATE: 8/19/2011

CASCADE SURVEYING & ENGINEERING, INC.
Engineers Surveyors Planners

P.O. BOX 328
ARLINGTON, WASHINGTON 98223
WWW.CASCADESURVEYING.COM

PHONE: (360) 435-5551
FAX: (360) 435-4012
TOLL FREE: 1-800-593-5551
(360) 435-5551



DESIGNED	R.D.	DATE	08/11	DRAWN	T.A.	DATE	08/11	CHECKED	R.L.D./P.F.	DATE	08/11	FIELD BOOK	ARL 128

REVISION	DATE	BY

**CITY OF ARLINGTON.
CENTENNIAL TRAIL
LAYOUT PLAN**

1 of 2

19216

V:\19216\DWG\CONSTRUCTION\19216 CENT TRLDWG (SHEET 1)



VERTICAL DATUM:
NAVD 1988

TBM 128-37-1
SET 60" SPIKE, 0.3' HIGH IN
N. FACE OF POWER POLE #1
ELEV.=135.62'

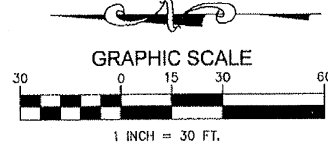

STA 6+87.77 MATCH LINE TO SHEET 1

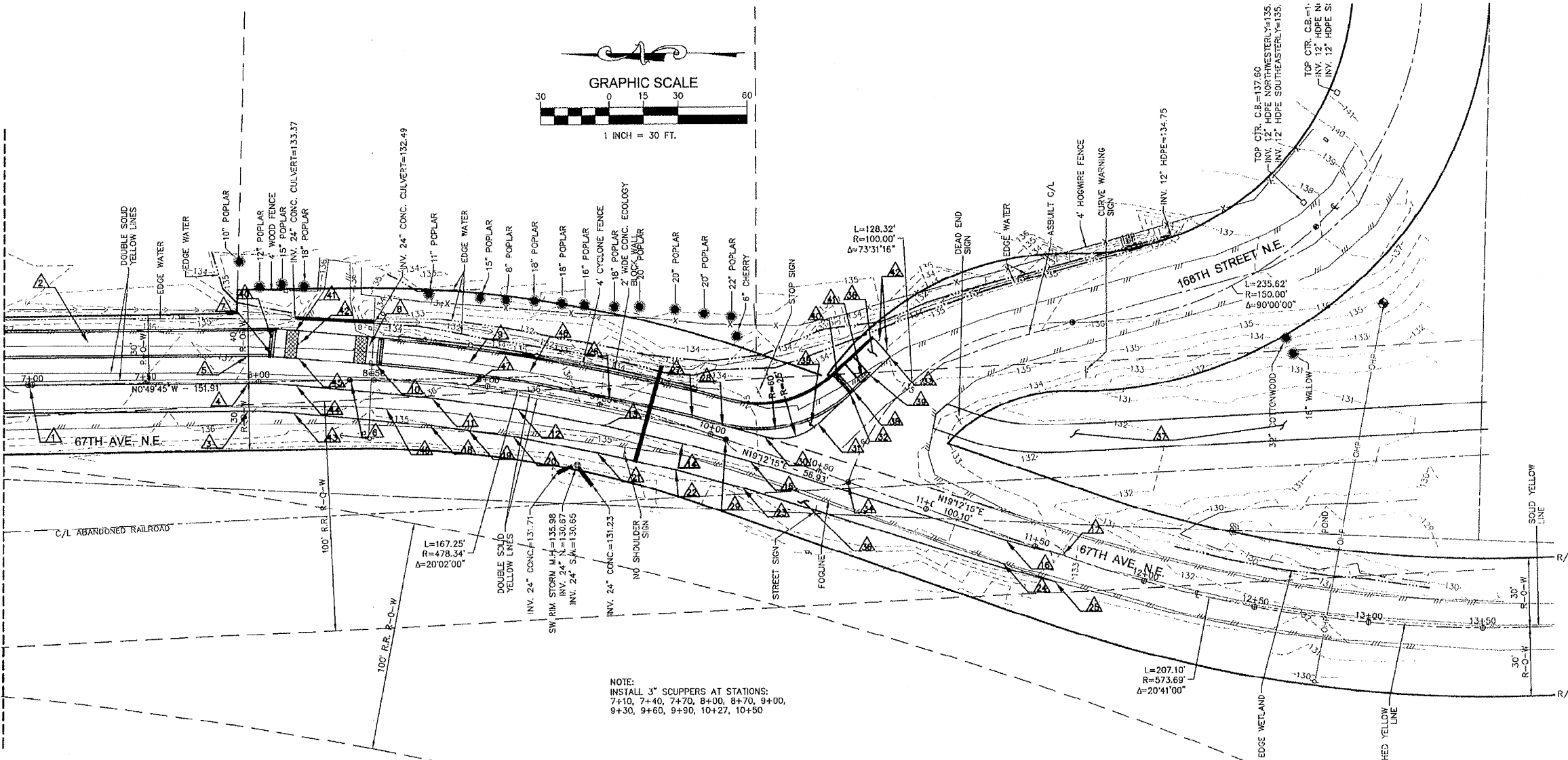

NOTE:
INSTALL 3" SCUPPERS AT STATIONS:
7+10, 7+40, 7+70, 8+00, 8+70, 9+00,
9+30, 9+60, 9+90, 10+27, 10+50

- KEY SCHEDULE & NOTES:**
- ▲ STA 8+98.14; 0.00' LT
PK NAIL SET IN ASPHALT
N 422194.18
E 1321334.25
 - ▲ FULL WIDTH CENTENNIAL TRAIL SECTION
(SEE DETAILS 1 & 2, SHEET 1).
 - ▲ STA 7+95.23; 12.93' RT
PC CURVE PAINTED LANE STRIPE
 - ▲ STA 7+95.32; 0.93' RT
PC CURVE PAINTED LANE STRIPE
 - ▲ STA 7+95.42; 11.07' LT
FULL CENTENNIAL TRAIL SECTION
PC CURVE 50 FT RADIUS
 - ▲ STA 8+39.69; 0.00' LT
PK NAIL SET IN ASPHALT
N 422052.63
E 1321336.30
 - ▲ 10 FT WIDE TRANSITION TO EXISTING DRIVEWAY.
 - ▲ 10 FT WIDE TRANSITION TO FULL WIDTH TRAIL
 - ▲ FULL WIDTH CENTENNIAL TRAIL SECTION
(SEE DETAILS 1 & 2, SHEET 1)
 - ▲ STA 8+51.08; 6.55' LT
BEGIN FULL WIDTH OF CENTENNIAL TRAIL
 - ▲ STA 8+76.30; 7.08' RT
ANGLE POINT PAINTED LANE STRIPE
 - ▲ STA 9+14.97; 8.32' RT
ANGLE POINT PAINTED LANE STRIPE.
 - ▲ STA 9+53.92; 8.77' RT
ANGLE POINT PAINTED LANE STRIPE
 - ▲ STA 9+89.59; 7.41' RT
ANGLE POINT PAINTED LANE STRIPE
 - ▲ STA 10+20.88; 5.54' RT
ANGLE POINT PAINTED LANE STRIPE
 - ▲ STA 10+37.86; 1.58' RT
ANGLE POINT PAINTED LANE STRIPE
 - ▲ STA 11+62.74; 0.18' LT
END PAINTED LANE STRIPE
 - ▲ STA 8+94.12; 20.04' RT
BEGIN NEW EDGE OF ASPHALT PAVEMENT

- KEY SCHEDULE & NOTES (CON'T):**
- ▲ STA 9+14.70; 20.32' RT
NEW EDGE OF ASPHALT PAVEMENT
 - ▲ STA 9+54.11; 20.77' RT
NEW EDGE OF ASPHALT PAVEMENT
 - ▲ STA 9+90.28; 19.40' RT
NEW EDGE OF ASPHALT PAVEMENT
 - ▲ STA 10+21.32; 17.52' RT
NEW EDGE OF ASPHALT PAVEMENT
 - ▲ STA 10+75.13; 16.00' RT
NEW EDGE OF ASPHALT PAVEMENT
 - ▲ STA 11+38.28; 13.57' RT
NEW EDGE OF ASPHALT PAVEMENT
 - ▲ STA 11+63.58; 11.80' RT
END OF NEW ASPHALT PAVEMENT
 - ▲ STA 9+53.74; 3.23' LT
ANGLE POINT CENTENNIAL TRAIL
 - ▲ STA 9+87.71; 4.48' LT
ANGLE POINT CENTENNIAL TRAIL
 - ▲ 10+03.63; 5.29' LT
PC CURVE CENTENNIAL TRAIL
 - ▲ STA 10+06.84; 0.00' LT
FND CONC. NAIL IN ASPHALT
N 421587.88
E 1321311.14
 - ▲ STA 10+22.75; 6.64' LT
PC CURVE PAINTED LANE STRIP
 - ▲ STA 10+42.98; 18.67' LT
PT CURVE PAINTED LANE STRIPE
 - ▲ STA 10+52.11; 36.56' LT
PT CURVE CENTENNIAL TRAIL
 - ▲ STA 10+63.48; 57.55' LT
BEGIN FULL WIDTH CENTENNIAL TRAIL
 - ▲ STA 10+63.87; 0.00' LT
FND CONC. NAIL IN ASPHALT
N 421634.60
E 1321291.00
 - ▲ STA 10+39.87; 18.01' LT
RELOCATE STOP SIGN
 - ▲ NEW ASPHALT AREA
 - ▲ PROPOSED 12 FT WIDE SNOHOMISH COUNTY TRAIL

- KEY SCHEDULE & NOTES (CON'T):**
- ▲ STA 10+53.00; 38.20' RT
BEGIN 10' WIDE TRANSITION
 - ▲ STA 10+57.76; 47.00' RT
END 10' WIDE TRANSITION
 - ▲ INSTALL STOP BAR AS DIRECTED
BY THE CITY OF ARLINGTON
 - ▲ ASPHALT GRIND AREA
2' X VARIES X 6' LONG
 - ▲ INSTALL BOLLARDS AS DIRECTED
BY THE CITY OF ARLINGTON
 - ▲ STA 8+15.03; 14.02' RT
PT CURVE PAINTED LANE STRIPE
 - ▲ STA 8+16.25; 2.08' RT
PT CURVE PAINTED LANE STRIPE
 - ▲ STA 8+17.47; 9.88' LT
PT CURVE PAINTED LANE STRIPE
 - ▲ REMOVE PAINTED LANE STRIPE
 - ▲ REMOVE PAINTED DOUBLE C/L STRIPE

- LEGEND:**
- DENOTES SEWER MANHOLE
 - DENOTES CATCH BASIN
 - DENOTES POWER POLE
 - DENOTES ELECTRIC BOX
 - DENOTES TELEPHONE PEDESTAL
 - DENOTES TRAFFIC SIGNAL JUNCTION BOX
 - ⊗ DENOTES LIGHT POLE
 - DENOTES MAILBOX
 - DENOTES 1.0" DIAMETER MAGNUM POWER CASE
 - X-X- DENOTES HOGWIRE FENCE
 - DENOTES CHAIN LINK FENCE
 - DENOTES WOOD FENCE
 - OHP- DENOTES POWER LINE
 - /// DENOTES EDGE OF ASPHALT
 - - - DENOTES CENTERLINE DITCH
 - DENOTES P.K. NAIL SET IN ASPHALT
 - DENOTES NAIL SET IN ASPHALT
 - DENOTES NEW ASPHALT PAVEMENT AREA

CASCADE & SURVEYING, INC.
Engineers Surveyors
Planners
P.O. BOX 308
ARLINGTON, WASHINGTON 98223
WWW.CASCADESURVEYING.COM
(360) 435-5551



NO.	REVISION	DATE	BY

DESIGNED	RLD	DATE	09/11
DRAWN	TAA	DATE	09/11
CHECKED	RLD/TEP	DATE	09/11
FIELD BOOK			ARL 128

CITY OF ARLINGTON.
CENTENNIAL TRAIL
LAYOUT PLAN

CITY OF ARLINGTON

THIS SHEET HAS BEEN APPROVED PER THE CONDITIONS ON THE COVER SHEET.

BY: *Eric Swartz*
CITY ENGINEER

DATE: *8/19/2011*

CALL TWO
BUSINESS DAYS
BEFORE YOU DIG
1-800-424-5555

PROVIDE ADDITIONAL BARRICADES ON ONE OR BOTH SIDES OF LINE OF BOLLARDS TO PREVENT VEHICULAR ACCESS ON TO TRAIL AS DIRECTED. BARRICADES MAY INCLUDE ROCK OR LOGS SALVAGED FROM SITE CLEARING. SEE SPECS.

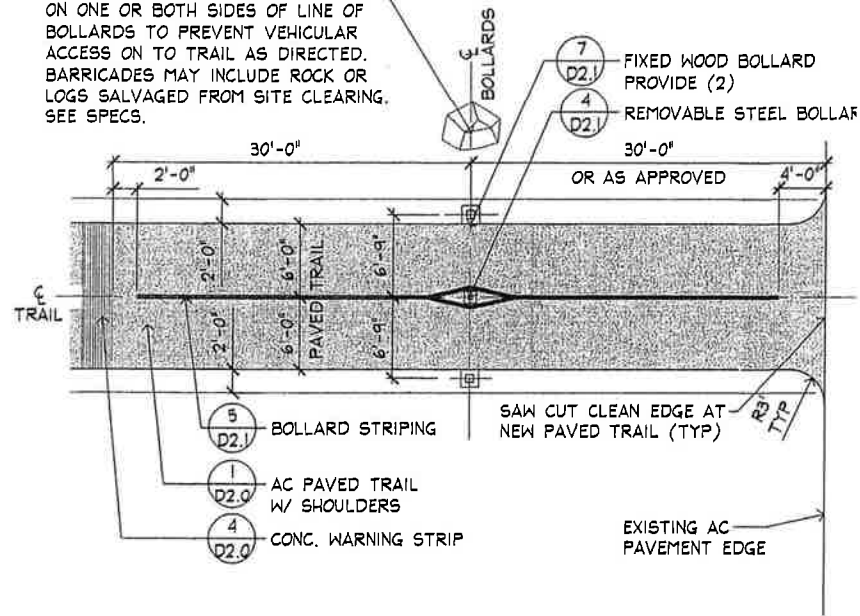

1 TYPICAL APPROACH TO CROSSING

SCALE: 1/8" = 1'-0"

CUT AND REMOVE 1" X 2" SLOT IN 4" PIPE TO ACCOMMODATE CHAIN. GRIND EDGES SMOOTH.

1/4" STEEL CHAIN, 10" LENGTH. WELD TO 4" PIPE.
1'-2" LONG, 4" SCH 40 STEEL PIPE

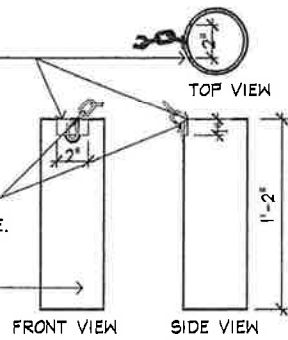

C GALVANIZED PIPE SLEEVE

5" COLLAR
3" SCH. 40 STEEL PIPE
STEEL LOCK TAB
STEEL ROD HANDLE
BOLLARD PLAN VIEW

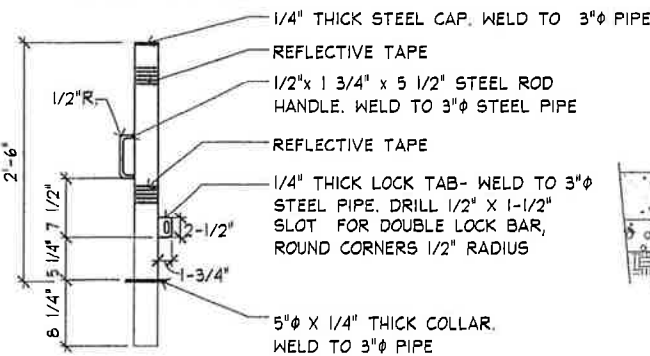

A BOLLARD ELEVATION

4 REMOVABLE STEEL BOLLARD

SCALE: NOT TO SCALE

3/8" X 1" X 4" STEEL FLAT BAR - 5/8" HOLE DRILLED IN EACH END
PADLOCK (TYP.)
DOUBLE LOCK BAR

CUT AND REMOVE 3" X 1/2" SLOT IN 1/4" THICK STEEL CAP FOR LOCK TAB. GRIND EDGES SMOOTH.

1/4" THICK STEEL CAP
1/4" STEEL CHAIN, 10" LENGTH. WELD TO BOTTOM OF 1/4" STEEL CAP.
LID - TOP VIEW

3" SCH. 40 PIPE - 2" LENGTH. WELD TO STEEL CAP
1/4" STEEL CHAIN, 10" LENGTH. WELD TO BOTTOM OF 1/4" STEEL CAP.
LID - SIDE VIEW

3" SCH. 40 PIPE - 2" LENGTH. WELD TO STEEL CAP
CUT AND REMOVE 2" WIDE X FULL DEPTH SLOT IN 3" PIPE PRIOR TO ATTACHMENT. GRIND EDGES SMOOTH.
LID - BOTTOM VIEW

D STEEL LID

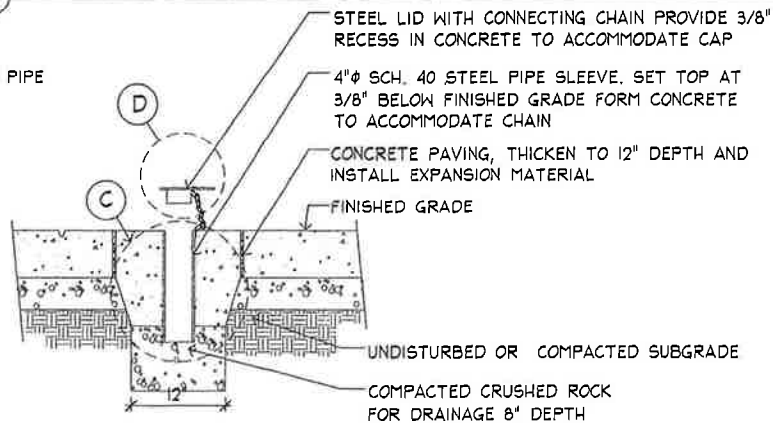

B SLEEVE IN CONCRETE SECTION VIEW

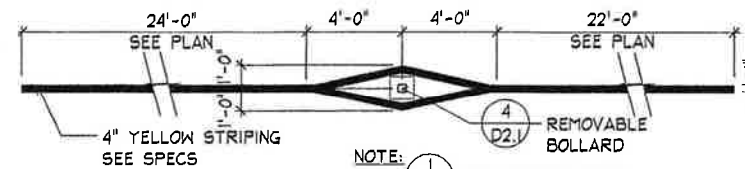

NOTE: SEE (1) FOR COORDINATION OF LAYOUT WITH BOLLARDS AND CONC. WARNING STRIP.

5 BOLLARD STRIPING

SCALE: 1/4" = 1'-0"

45° CHAMFER
AFFIX REFLECTIVE BUTTON HERE AND ON OPPOSITE SIDE PER WSDOT SPECS.

8" X 8" ROUGH SAWN PRESSURE TREATED WOOD POST 4'-6" INSIDE DIMENSION, SET PLUMB

FINISH GRADE

CONCRETE

UNDISTURBED SUB-GRADE

7 FIXED WOOD BOLLARD

SCALE: 1" = 1'-0"

REVISIONS:	DATE

CENTENNIAL TRAIL		SHEET
SCALE: AS NOTED	CONSTRUCTION DETAILS	D2.1
DATE:		
DRAWN BY:		
CHECKED BY:		
JOB NO.:		